

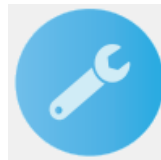

MClimate MC-LW-BTN-01 Multipurpose Button LoRaWAN User Manual

[Home](#) » [MClimate](#) » MClimate MC-LW-BTN-01 Multipurpose Button LoRaWAN User Manual 



**MClimate Multipurpose Button LoRaWAN®
User manual**

Scan the QR Code to access MClimate Multipurpose Button LoRaWAN® extended documentation





mclimate.eu/lorawan-resources

Need some help?



For more product information and issues related to it, visit climate.eu/lorawan-resources or write us to: lorawan-support@mclimate.eu

 00359 800 3 1010
Monday-Friday 09:00 – 18:00

 **Sofia, Bulgaria**
Aleksandar Malinov Boulevard 31, Campus X, Building 2, floor 1, office 1-2

Contents

- 1 What's inside the box?
- 2 Technical specifications
- 3 Safety Instructions
- 4 Legal Notices
- 5 Compatibility
- 6 Device parts
- 7 LED, Buttons, and behavior
- 8 Commissioning
- 9 Installation
- 10 Documents / Resources
 - 10.1 References
- 11 Related Posts

What's inside the box?



MClimate Multipurpose Button LoRaWAN®

Technical specifications

Description: LoRaWAN Button with temperature sensor and 3 types of button presses (single, double, and triple

press) Created by MClimate™

Model: MC-LW-BTN-01

Dimensions: 71 x 41 x 18mm

Weight: 26gr

Frequency range: 863÷870MHz

Power supply: 1xER10280 3VDC

battery Sensors: built-in temperature sensor

Work temperature: 0°C to +50°C

Material: ABS

Environmental conditions, in which the device is intended to operate:

- Indoor using;
- for altitude up to 2000m;
- for an ambient temperature:0°C to +50°C;
- for a maximum relative humidity of 80% for temperatures up to 31°C, decreasing linearly to 25% relative humidity at temperature 50°C;
- for the environment with a degree of contamination 2 (PD2).

Storage and transportation conditions:

- for an ambient temperature :-40°C to +85°C;
- for relative humidity 5% to 90% without condensation

Manufacturer

Melissa Climate Jsc
Gen. Gurko 4 street
1000 Sofia, Bulgaria

Compliance with the WEEE Directive

The appliance marked with this symbol should not be disposed of with other household waste. It must be handed over to the relevant collection point for the recycling of electrical and electronic equipment.



Safety Instructions

Please read the safety instructions before installing the device! Failure to follow the recommended instructions in this manual may be dangerous or in violation of the law. The manufacturer Melissa Climate Jsc., is not responsible for any loss or damage caused by failure to follow the instructions in the operating manual.

Legal Notices

All information, including but not limited to, features, functionality, and/or other product specifications are subject to change without notice. climate retains all rights to review or update its products, software, or documentation without being required to notify any natural or legal person.

The climate and MClimate logo are trademarks of Melissa Climate Jsc. All other brands and product names mentioned herein are trademarks of their respective owners.

EU Declaration of Conformity

This device complies with the essential requirements and other applicable provisions of the following EU directives:

2014/53/EC

EN 50491-3:2009

EEU 300 220-1 V3.1.1:2017

EEU 300 220-2 V3.1.1:2017

EN 60950-1:2006+A11:2009 +A1:2010+A12:2011+

A2:2013 + AC:2015

EN 301 489-1 V2.1.1:2017

Compatibility

In order to operate MClimate Multipurpose Button LoRaWAN®, you will need: the LoRaWAN® network
Battery

Battery type: 1xER10280, 3VDC Device operating voltage: 2.7 – 3VDC

Device parts



LED, Buttons, and behavior

There are three separate types of clicks supported by the button.

After each click, the button waits for 600ms to check if another click is coming. Once the click type has been determined, the device sends a confirmed uplink with the temperature data and the click type information.

Supported click types:



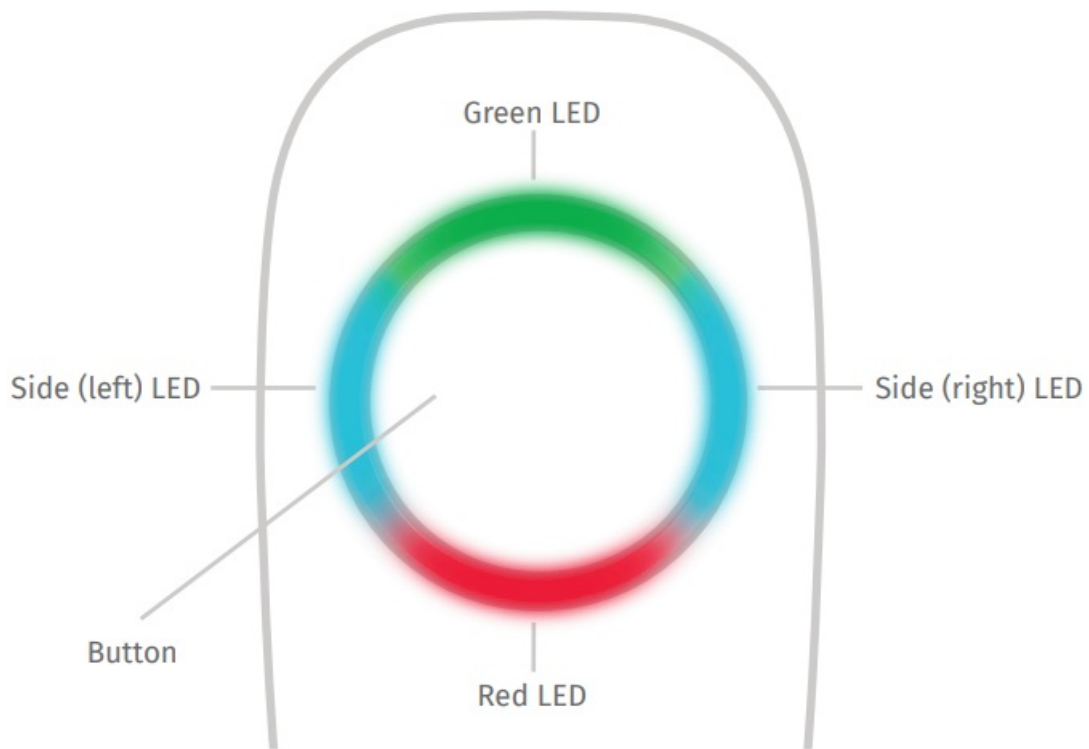

LEDs indications:

- The GREEN LED is activated while the button is pressed
- The side LEDs alternate when the LoRaWAN message is being sent
- The GREEN LED lights up when the event is sent and acknowledged by the gateway and LNS
- If the message has not been successfully acknowledged, the RED LED activates
- If a message is not allowed to be sent at the moment (due to RF duty-cycle restrictions), the RED light activates after you release the button.
- If the sensor is NOT connected to a network, then the SIDE and RED LEDs activate.

Commissioning

1. Open your LoRaWAN® Network provider access panel and add the device using the supplied Serial Number, DevEUI, AppEUI (JoinEUI), and AppKey.

Device ID: 9X7621HS

DevEUI: 70B3D25DD30009E1

AppEUI: 70B3D25DD3000000

AppKey: a0658dfae72131saf1249abc11

Register



The data is an example. Do not use.

2. Continue the Installation with the instructions of your LoRaWAN® Network provider.

MClimate_LoRaWAN_51177

Serial Number	DevEui	AppEui	AppKey
G11PBE30000000000000000000000000000000	70B3D25DD30009E1	70B3D25DD3000000	5fc310444c30948a438f103a279a20



You can get DevEUI, AppEUI (JoinEUI) & AppKey information from the LoRaWAN® credentials .csv file we sent you with the fulfillment confirmation.

Remove the battery paper isolator from the device.

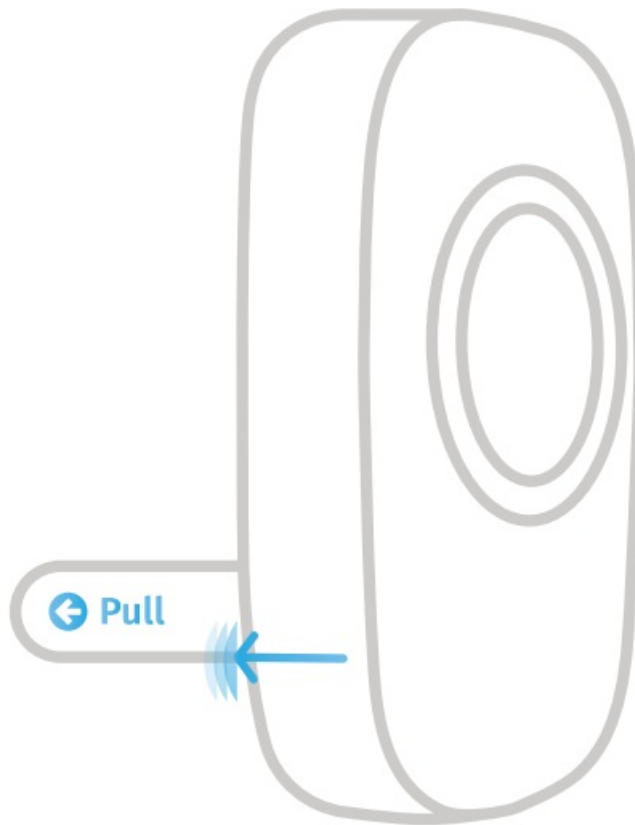

Open the device

If you need to open the device to replace the battery, use the slot indicated in the picture to open the device. Insert the new battery following the direction indicated on the PCB.

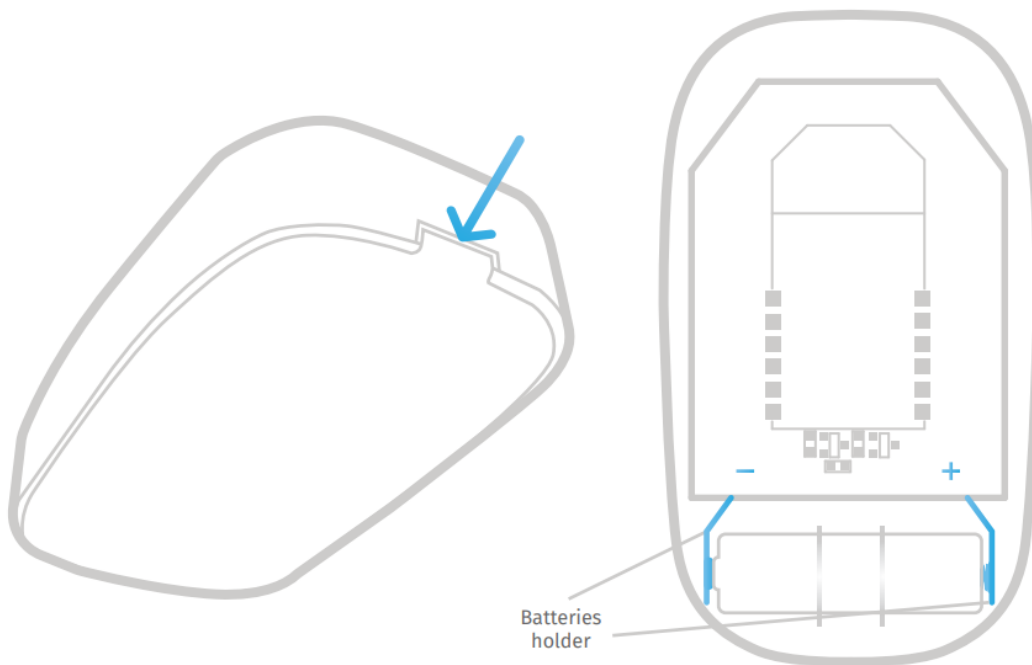

Disassembled MClimate Multipurpose Button LoRaWAN®, top view

Installation

We recommend installing the device in an open environment (e.g. not in a recess) at 1.5m height. Do not install the device near big metal items as it will worsen the RF performance. Use double-sided tape to attach it to the surface.

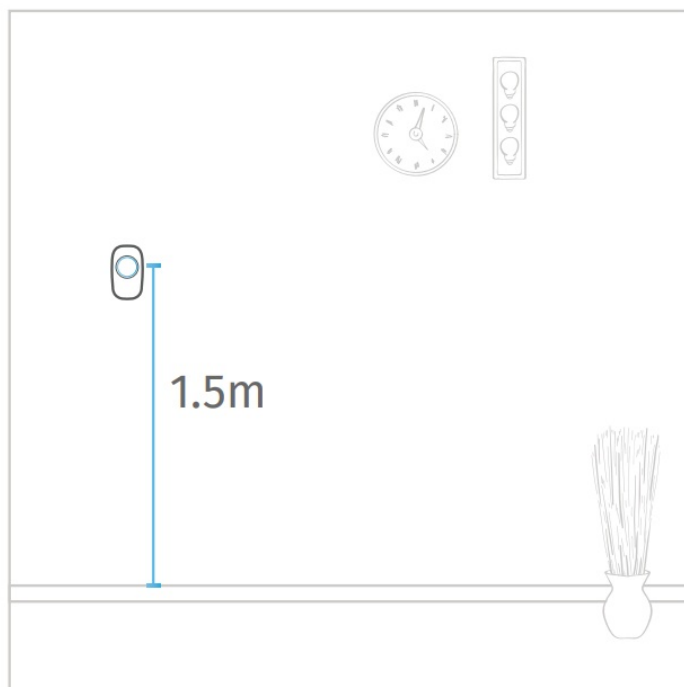
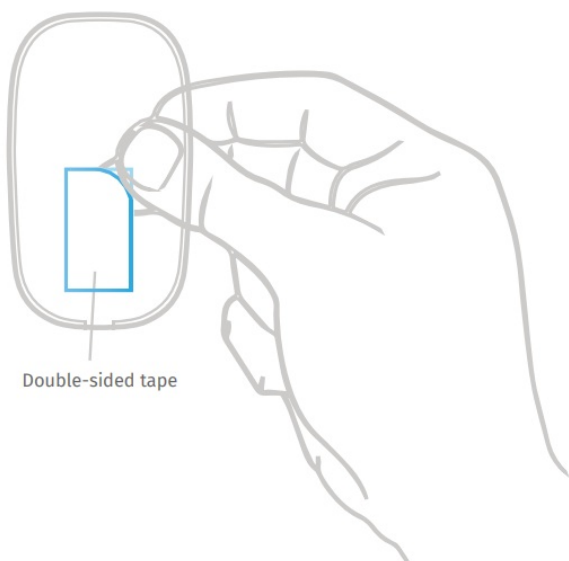

Capter – Transmettre – Analyser

Interlaces pour Pint ouroupue industrielle

Remy GUEDOT

Gsm: +33 (0) 662 80 65 57 guedot@rg2i.fr

Olivier BENAS Gsm: +33 (0) 666 84 26 26 olivier.benas

ATTENTION HOUVIlif ADILESSI

14 rue Edouard Petit – F42000 Saint Etienne

Tel: +33 (0) 477 92 03 56 – Fax: +33 (0) 477 92 03 57

www.erg2i.fr



www.mclimate.eu

Designed & Manufactured by MClimate in Europe.

last update: 20.01.2022

Documents / Resources



[MClimate MC-LW-BTN-01 Multipurpose Button LoRaWAN](#) [pdf] User Manual
MC-LW-BTN-01, Multipurpose Button LoRaWAN, MC-LW-BTN-01 Multipurpose Button LoRaWAN

References

- [LoRaWAN Resources | MClimate](#)
- [MClimate | MClimate - We make any building smart](#)

Manuals+