

[Home \(/xwiki/bin/view/Main/\)](#) / [User Manual for LoRaWAN End Nodes \(/xwiki/bin/view/Main/User%20Manual%20for%20LoRaWAN%20End%20Nodes/\)](#) / [SN50v3-LB LoRaWAN Sensor Node User Manual \(/xwiki/bin/view/Main/User%20Manual%20for%20LoRaWAN%20End%20Nodes/SN50v3-LB/\)](#)

SN50v3-LB LoRaWAN Sensor Node User Manual

Last modified by Xiaoling (/xwiki/bin/view/XWiki/Xiaoling) on 2023/06/12 10:39



Table of Contents:

- 1. Introduction
 - 1.1 What is SN50v3-LB LoRaWAN Generic Node
 - 1.2 Features
 - 1.3 Specification
 - 1.4 Sleep mode and working mode
 - 1.5 Button & LEDs
 - 1.6 BLE connection
 - 1.7 Pin Definitions
 - 1.8 Mechanical
 - 1.9 Hole Option
- 2. Configure SN50v3-LB to connect to LoRaWAN network
 - 2.1 How it works
 - 2.2 Quick guide to connect to LoRaWAN server (OTAA)
 - 2.3 Uplink Payload
 - 2.3.1 Device Status, FPORT=5
 - 2.3.2 Working Modes & Sensor Data. Uplink via FPORT=2
 - 2.3.2.1 MOD=1 (Default Mode)
 - 2.3.2.2 MOD=2 (Distance Mode)
 - 2.3.2.3 MOD=3 (3 ADC + I2C)
 - 2.3.2.4 MOD=4 (3 x DS18B20)
 - 2.3.2.5 MOD=5 (Weight Measurement by HX711)
 - 2.3.2.6 MOD=6 (Counting Mode)
 - 2.3.2.7 MOD=7 (Three interrupt contact modes)
 - 2.3.2.8 MOD=8 (3ADC+1DS18B20)
 - 2.3.2.9 MOD=9 (3DS18B20+ two Interrupt count mode)
 - 2.3.3 Decode payload
 - 2.3.3.1 Battery Info
 - 2.3.3.2 Temperature (DS18B20)
 - 2.3.3.3 Digital Input
 - 2.3.3.4 Analogue Digital Converter (ADC)
 - 2.3.3.5 Digital Interrupt
 - 2.3.3.6 I2C Interface (SHT20 & SHT31)
 - 2.3.3.7 Distance Reading

- 2.3.3.8 Ultrasonic Sensor
 - 2.3.3.9 Battery Output - BAT pin
 - 2.3.3.10 +5V Output
 - 2.3.3.11 BH1750 Illumination Sensor
 - 2.3.3.12 Working MOD
 - 2.4 Payload Decoder file
 - 2.5 Frequency Plans
- 3. Configure SN50v3-LB
 - 3.1 Configure Methods
 - 3.2 General Commands
 - 3.3 Commands special design for SN50v3-LB
 - 3.3.1 Set Transmit Interval Time
 - 3.3.2 Get Device Status
 - 3.3.3 Set Interrupt Mode
 - 3.3.4 Set Power Output Duration
 - 3.3.5 Set Weighing parameters
 - 3.3.6 Set Digital pulse count value
 - 3.3.7 Set Workmode
- 4. Battery & Power Consumption
- 5. OTA Firmware update
- 6. FAQ
 - 6.1 Where can i find source code of SN50v3-LB?
- 7. Order Info
- 8. Packing Info
- 9. Support

1. Introduction

1.1 What is SN50v3-LB LoRaWAN Generic Node

SN50V3-LB LoRaWAN Sensor Node is a Long Range LoRa Sensor Node. It is designed for outdoor use and powered by **8500mA Li/SOCI2 battery** for long term use. S developers to quickly deploy industrial level LoRa and IoT solutions. It help users to turn the idea into a practical application and make the Internet of Things a reality. It is your things everywhere.

SN50V3-LB wireless part is based on SX1262 allows the user to send data and reach extremely long ranges at low data-rates. It provides ultra-long range spread spectr interference immunity whilst minimising current consumption. It targets professional wireless sensor network applications such as irrigation systems, smart metering, smar automation, and so on.

SN50V3-LB has a powerful 48Mhz ARM microcontroller with 256KB flash and 64KB RAM. It has multiplex I/O pins to connect to different sensors.

SN50V3-LB has a built-in BLE module, user can configure the sensor remotely via Mobile Phone. It also support OTA upgrade via private LoRa protocol for easy maintai

SN50V3-LB is the 3rd generation of LSN50 series generic sensor node from Dragino. It is an **open source project** and has a mature LoRaWAN stack and application sof software for their IoT projects or easily customize the software for different requirements.

1.2 Features

- LoRaWAN 1.0.3 Class A
- Ultra-low power consumption
- Open-Source hardware/software
- Bands: CN470/EU433/KR920/US915/EU868/AS923/AU915/IN865
- Support Bluetooth v5.1 and LoRaWAN remote configure
- Support wireless OTA update firmware
- Uplink on periodically
- Downlink to change configure
- 8500mAh Battery for long term use

1.3 Specification

Common DC Characteristics:

- Supply Voltage: built in 8500mAh Li-SOCI2 battery , 2.5v ~ 3.6v
- Operating Temperature: -40 ~ 85°C

I/O Interface:

- Battery output (2.6v ~ 3.6v depends on battery)
- +5v controllable output
- 3 x Interrupt or Digital IN/OUT pins
- 3 x one-wire interfaces
- 1 x UART Interface
- 1 x I2C Interface

LoRa Spec:

- Frequency Range, Band 1 (HF): 862 ~ 1020 Mhz
- Max +22 dBm constant RF output vs.
- RX sensitivity: down to -139 dBm.
- Excellent blocking immunity

Battery:

- Li/SOCI2 un-chargeable battery
- Capacity: 8500mAh
- Self-Discharge: <1% / Year @ 25°C
- Max continuously current: 130mA
- Max boost current: 2A, 1 second

Power Consumption

- Sleep Mode: 5uA @ 3.3v
- LoRa Transmit Mode: 125mA @ 20dBm, 82mA @ 14dBm

1.4 Sleep mode and working mode

Deep Sleep Mode: Sensor doesn't have any LoRaWAN activate. This mode is used for storage and shipping to save battery life.

Working Mode: In this mode, Sensor will work as LoRaWAN Sensor to Join LoRaWAN network and send out sensor data to server. Between each sampling/tx/rx period IDLE mode, sensor has the same power consumption as Deep Sleep mode.

1.5 Button & LEDs

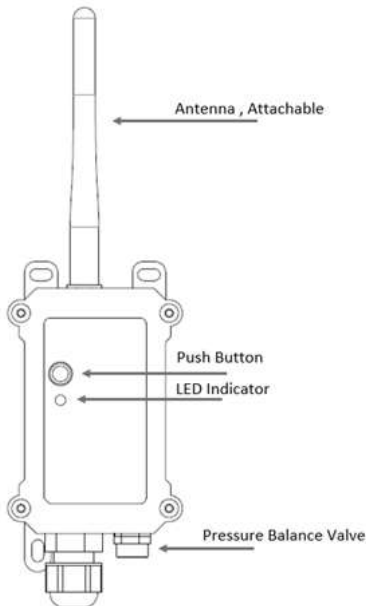

Behavior on ACT	Function	Action
Pressing ACT between 1s < time < 3s	Send an uplink	If sensor is already Joined to LoRaWAN network, sensor will send an uplink packet, blue led will blink once. Meanwhile, BLE module will be active and user can connect via BLE to configure device.
Pressing ACT for more than 3s	Active Device	Green led will fast blink 5 times, device will enter OTA mode for 3 seconds. And then start to JOIN LoRaWAN network. Green led will solidly turn on for 5 seconds after joined in network. Once sensor is active, BLE module will be active and user can connect via BLE to configure device, no matter if device join or not join LoRaWAN network.

Fast press ACT 5 times.	Deactivate Device	Red led will solid on for 5 seconds. Means device is in Deep Sleep Mode.
-------------------------	-------------------	---

1.6 BLE connection

SN50v3-LB supports BLE remote configure.

BLE can be used to configure the parameter of sensor or see the console output from sensor. BLE will be only activate on below case:

- Press button to send an uplink
- Press button to active device.
- Device Power on or reset.

If there is no activity connection on BLE in 60 seconds, sensor will shut down BLE module to enter low power mode.

1.7 Pin Definitions

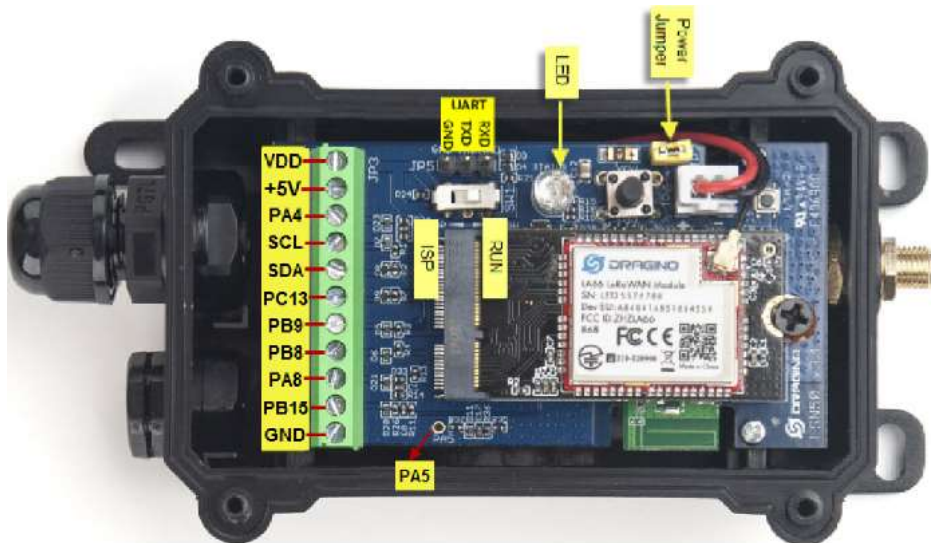

1.8 Mechanical

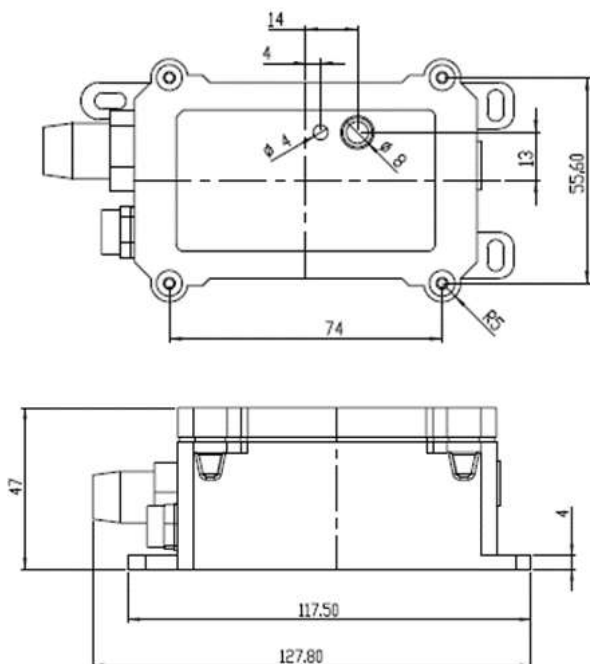

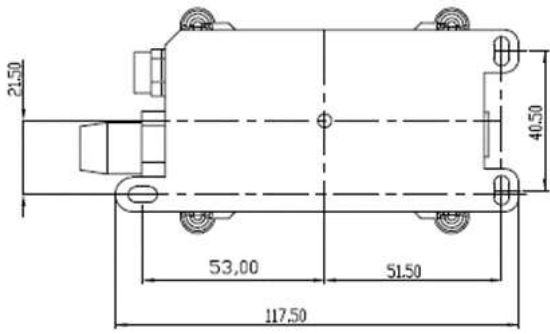

1.9 Hole Option

SN50v3-LB has different hole size options for different size sensor cable. The options provided are M12, M16 and M20. The definition is as below:



多项国际质量认证



品质保证放心使用

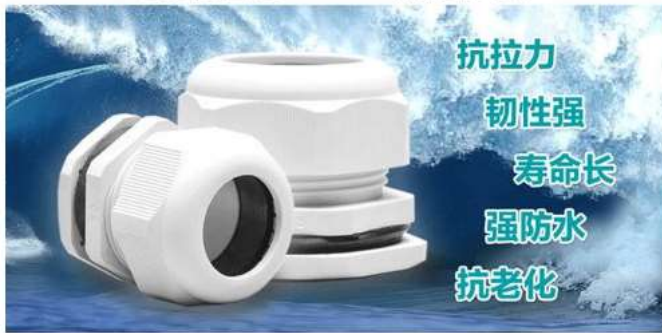

产品结构 Structure

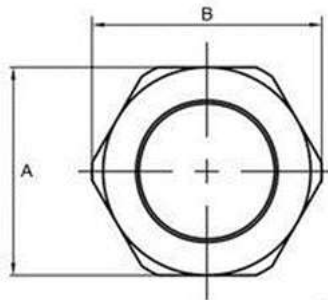
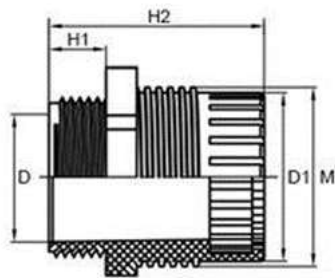
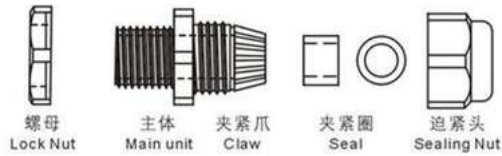

单位: mm

MODEL	H1	H2	M	M1	D	D1	A	B
M12*1.5	8	28.3	12.0	12.0	10.4	8.5 ± 0.2	16 ± 0.2	18 ± 0.2
M16*1.5	8	30.7	15.1	16.0	13.5	10.9 ± 0.2	18.8 ± 0.2	20.6 ± 0.2
M20*1.5	9	34.0	20.2	20.0	18.7	16.2 ± 0.2	22.8 ± 0.2	25.2 ± 0.2

2. Configure SN50v3-LB to connect to LoRaWAN network

2.1 How it works

The SN50v3-LB is configured as **LoRaWAN OTAA Class A** mode by default. It has OTAA keys to join LoRaWAN network. To connect a local LoRaWAN network, you need a LoRaWAN IoT server and press the button to activate the SN50v3-LB. It will automatically join the network via OTAA and start to send the sensor value. The default uplink

2.2 Quick guide to connect to LoRaWAN server (OTAA)

Following is an example for how to join the TTN v3 LoRaWAN Network (<https://console.cloud.thethings.network/>). Below is the network structure; we use the LPS8v2 (lorawan-gateway/item/228-lps8v2.html) as a LoRaWAN gateway in this example.

The LPS8v2 is already set to connected to TTN network (<https://console.cloud.thethings.network/>), so what we need to now is configure the TTN server.

Step 1: Create a device in TTN with the OTAA keys from SN50v3-LB.

Each SN50v3-LB is shipped with a sticker with the default device EUI as below:



You can enter this key in the LoRaWAN Server portal. Below is TTN screen shot:

Register the device

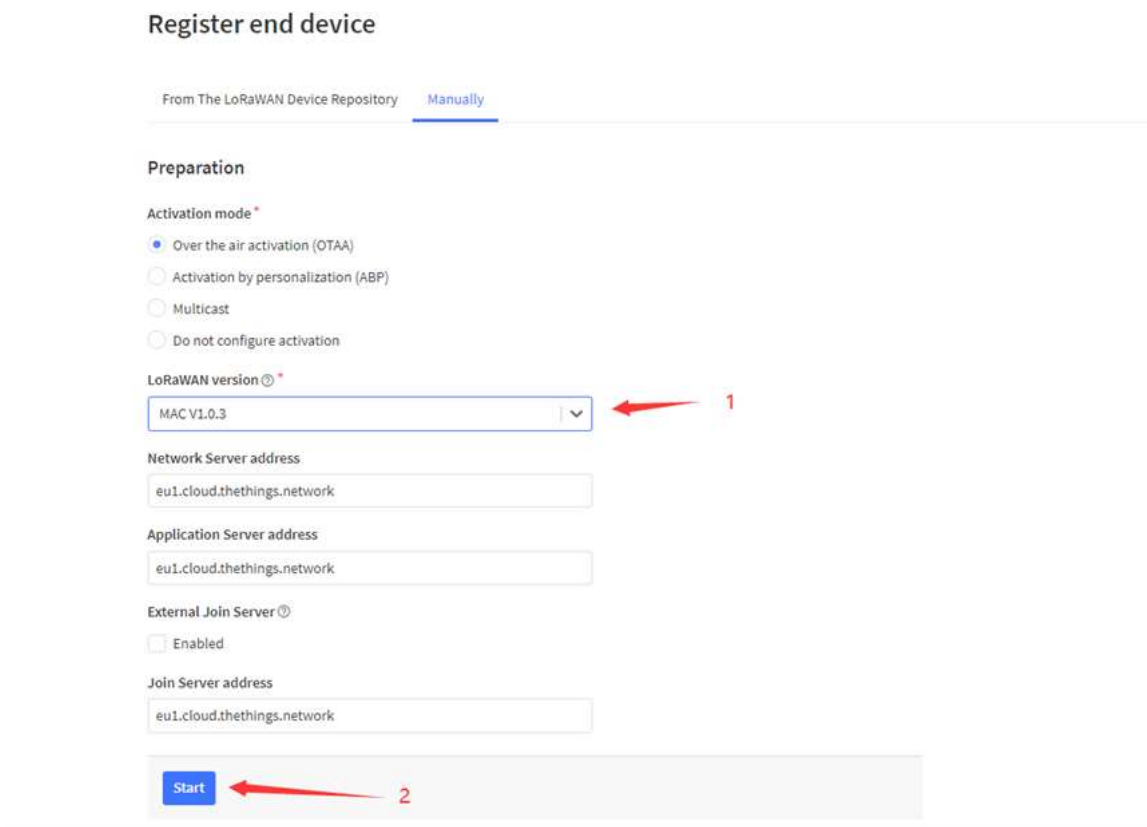

Add APP EUI and DEV EUI

Register end device

From The LoRaWAN Device Repository **Manually**

1 Basic settings End device ID's, Name and Description

2 Network layer settings Frequency plan, regional parameters, end device class and session keys.

3 Join settings Root keys, NetID and kek labels.

End device ID [?] *

AppEUI [?] *

DevEUI [?] *

End device name

End device description

Optional end device description; can also be used to save notes about the end device

[Network layer settings >](#)

Add APP EUI in the application

Register end device

From The LoRaWAN Device Repository **Manually**

1 Basic settings End device ID's, Name and Description

2 Network layer settings Frequency plan, regional parameters, end device class and session keys.

3 Join settings Root keys, NetID and kek labels.

Frequency plan [?] *

LoRaWAN version [?] *

Regional Parameters version [?] *

LoRaWAN class capabilities [?]

Supports class B

Supports class C

Advanced settings ▾

[< Basic settings](#) [Join settings >](#)

Add APP KEY

Register end device

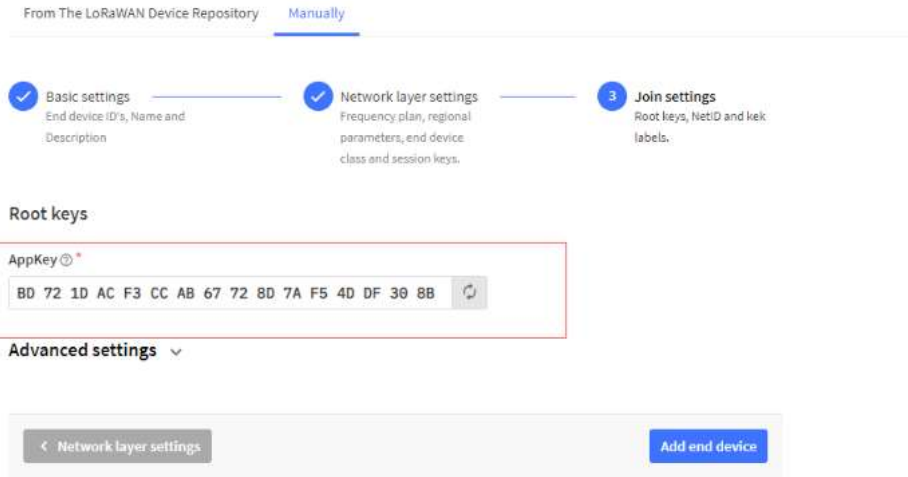

Step 2: Activate SN50v3-LB

Press the button for 5 seconds to activate the SN50v3-LB.

Green led will fast blink 5 times, device will enter **OTA mode** for 3 seconds. And then start to JOIN LoRaWAN network. **Green led** will solidly turn on for 5 seconds after j
After join success, it will start to upload messages to TTN and you can see the messages in the panel.

2.3 Uplink Payload

2.3.1 Device Status, FPORT=5

Users can use the downlink command(**0x26 01**) to ask SN50v3-LB to send device configure detail, include device configure status. SN50v3-LB will uplink a payload via F
The Payload format is as below.

Device Status (FPORT=5)					
Size (bytes)	1	2	1	1	2
Value	Sensor Model	Firmware Version	Frequency Band	Sub-band	BAT

Example parse in TTNv3

Sensor Model: For SN50v3-LB, this value is 0x1C

Firmware Version: 0x0100, Means: v1.0.0 version

Frequency Band:

- *0x01: EU868
- *0x02: US915
- *0x03: IN865
- *0x04: AU915
- *0x05: KZ865
- *0x06: RU864
- *0x07: AS923
- *0x08: AS923-1
- *0x09: AS923-2
- *0x0a: AS923-3
- *0x0b: CN470
- *0x0c: EU433
- *0x0d: KR920
- *0x0e: MA869

Sub-Band:

AU915 and US915:value 0x00 ~ 0x08

CN470: value 0x0B ~ 0x0C

Other Bands: Always 0x00

Battery Info:

Check the battery voltage.

Ex1: 0x0B45 = 2885mV

Ex2: 0x0B49 = 2889mV

2.3.2 Working Modes & Sensor Data. Uplink via FPORT=2

SN50v3-LB has different working mode for the connections of different type of sensors. This section describes these modes. Use can use the AT Command **AT+MOD** to set modes.

For example:

AT+MOD=2 // will set the SN50v3 to work in MOD=2 distance mode which target to measure distance via Ultrasonic Sensor.

Important Notice:

1. Some working modes has payload more than 12 bytes, The US915/AU915/AS923 frequency bands' definition has maximum 11 bytes in **DR0**. Server sides will see NUDR0 with 12 bytes payload.
2. All modes share the same Payload Explanation from HERE.
3. By default, the device will send an uplink message every 20 minutes.

2.3.2.1 MOD=1 (Default Mode)

In this mode, uplink payload includes in total 11 bytes. Uplink packets use FPORT=2.

Size(bytes)	2	2	2	1	2	2
Value	Bat	Temperature(DS18B20) (PC13)	ADC(PA4)	Digital in(PB15)&Digital Interrupt(PA8)	Temperature(SHT20 or SHT31 or BH1750 Illumination Sensor)	Humidity(SHT20 or SHT31)

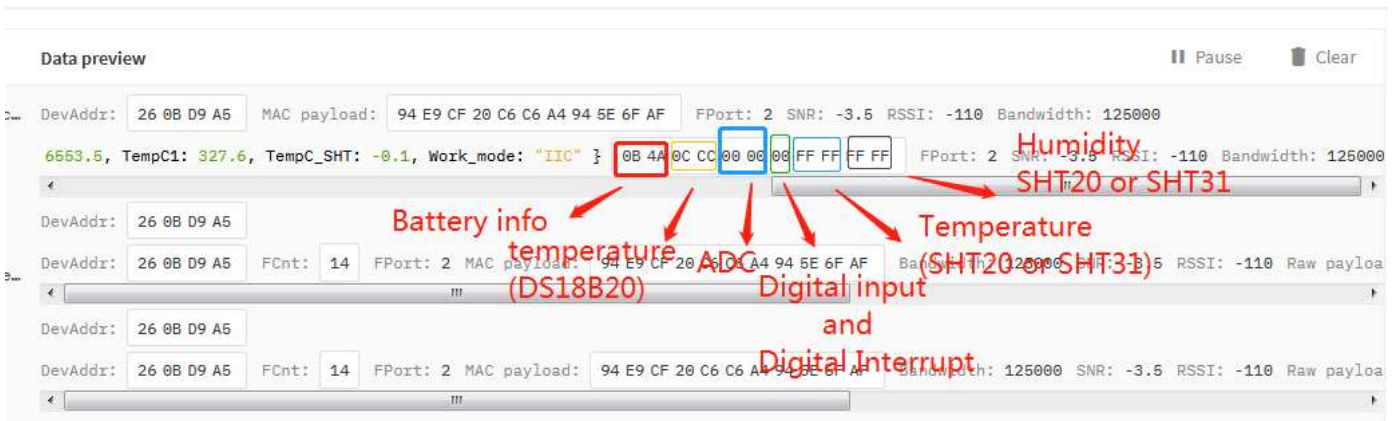

2.3.2.2 MOD=2 (Distance Mode)

This mode is target to measure the distance. The payload of this mode is totally 11 bytes. The 8th and 9th bytes is for the distance.

Size(bytes)	2	2	2	1	2	2
Value	BAT	Temperature(DS18B20) (PC13)	ADC(PA4)	Digital in(PB15) & Digital Interrupt(PA8)	Distance measure by:1) LIDAR-Lite V3HP Or 2) Ultrasonic Sensor	Reserved

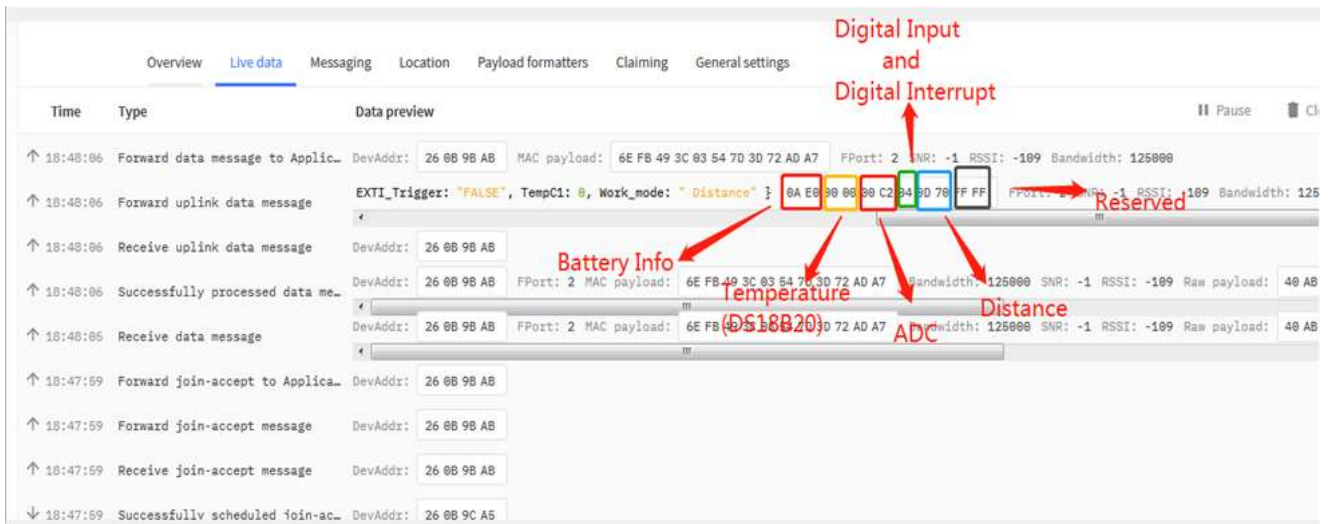

Connection of LIDAR-Lite V3HP:

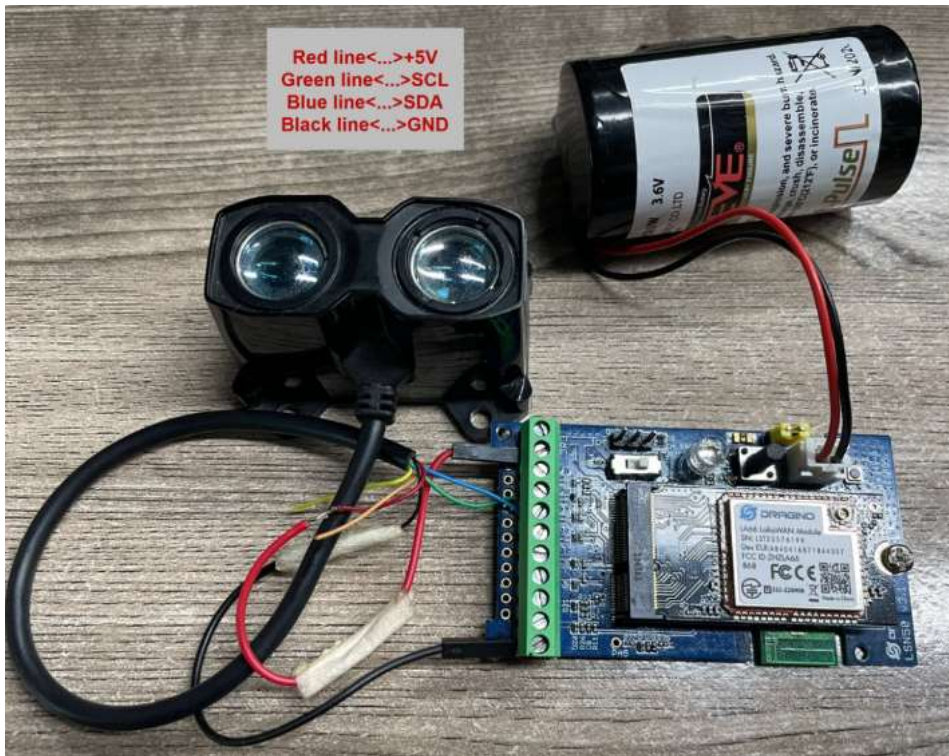

Connection to Ultrasonic Sensor:

Need to remove R1 and R2 resistors to get low power, otherwise there will be 240uA standby current.

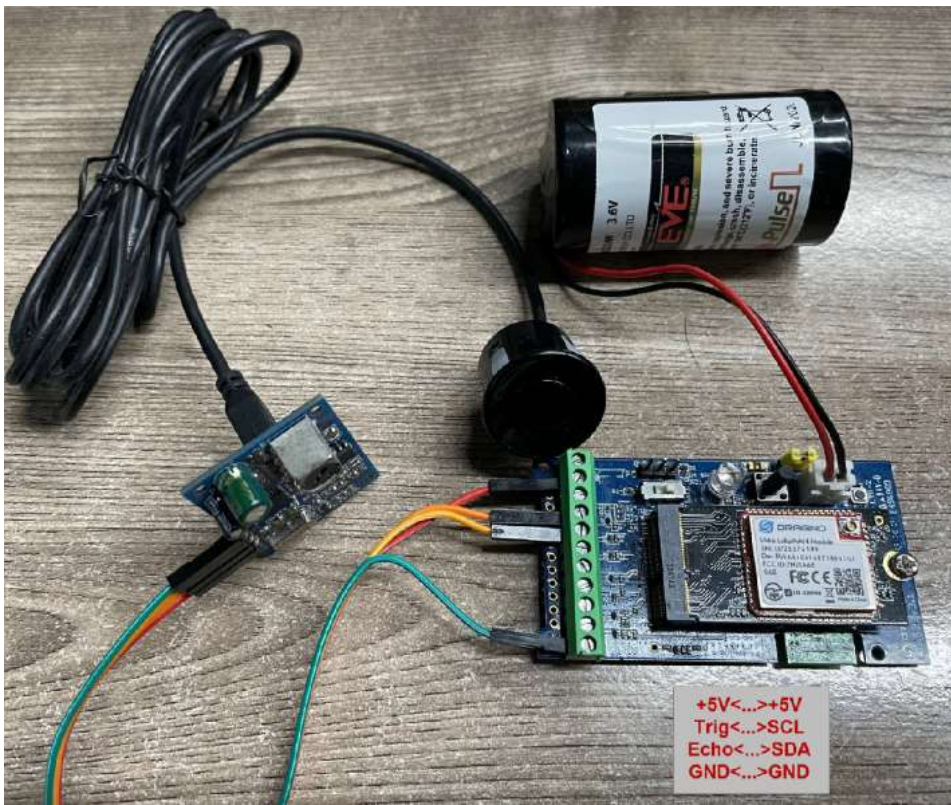

For the connection to TF-Mini or TF-Luna , MOD2 payload is as below:

Size(bytes)	2	2	1	2	2	2
Value	BAT	Temperature(DS18B20) (PC13)	Digital in(PB15) & Digital Interrupt(PA8)	ADC(PA4)	Distance measure by:1)TF- Mini plus LiDAR Or 2) TF- Luna LiDAR	Distance signal strength

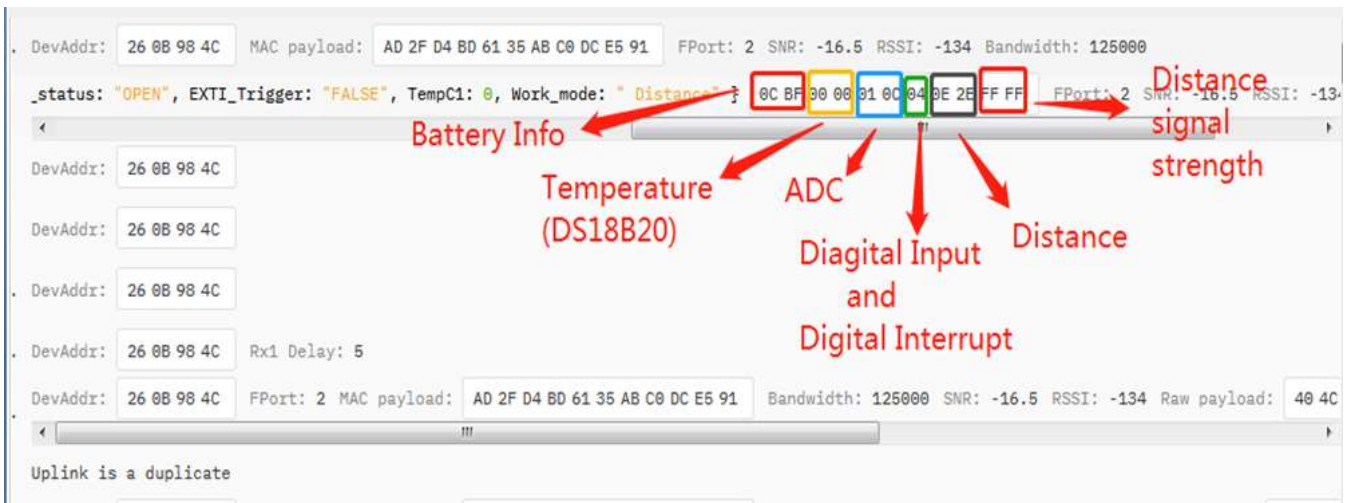

Connection to TF-Mini plus (<http://en.benewake.com/product/detail/5c345cd0e5b3a844c472329b.html>) LiDAR(UART version):

Need to remove R3 and R4 resistors to get low power,otherwise there will be 400uA standby current.

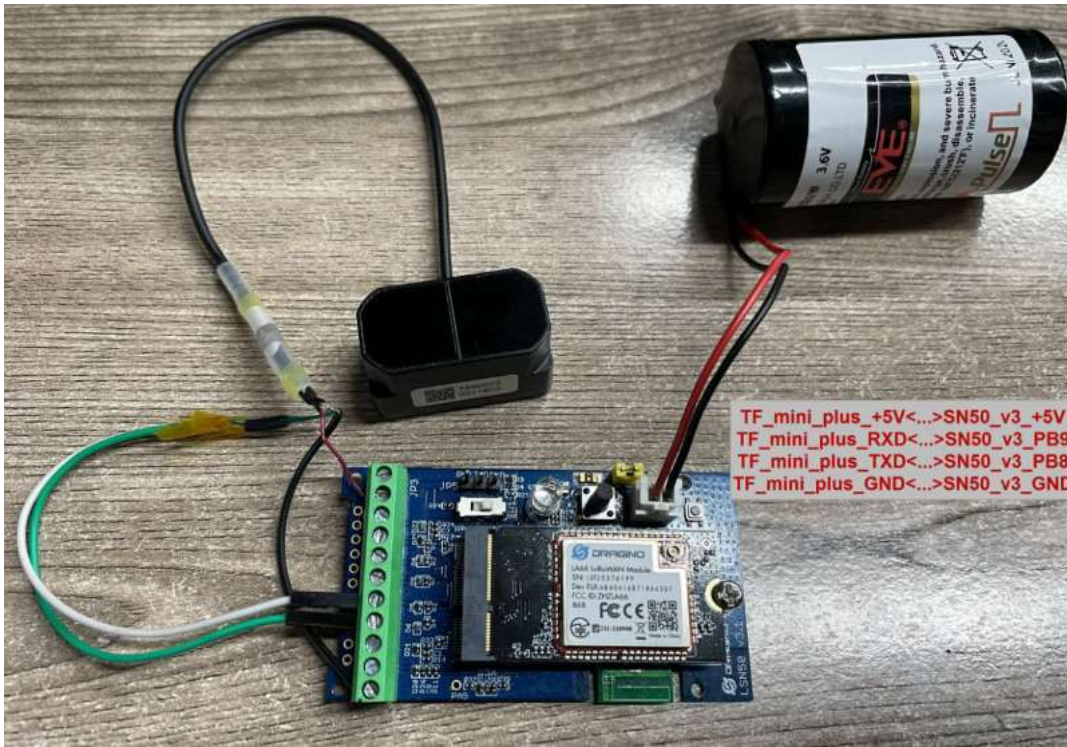

Connection to TF-Luna (<http://en.benewake.com/product/detail/5e1c1fd04d839408076b6255.html>) LiDAR (UART version):
 Need to remove R3 and R4 resistors to get low power, otherwise there will be 400uA standby current.

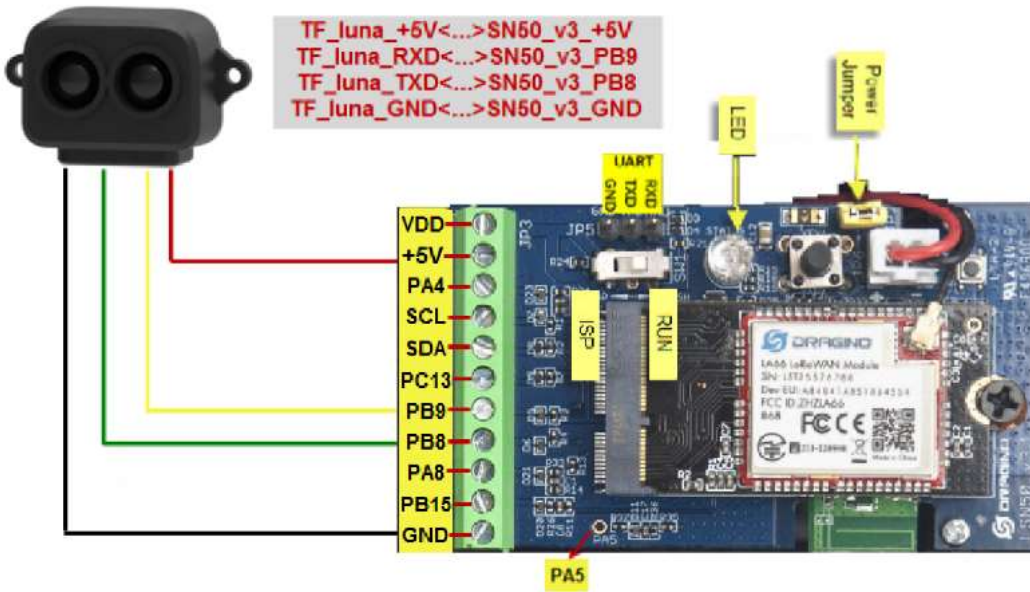

2.3.2.3 MOD=3 (3 ADC + I2C)

This mode has total 12 bytes. Include 3 x ADC + 1x I2C

Size(bytes)	2	2	2	1	2	2	1
Value	ADC1(PA4)	ADC2(PA5)	ADC3(PA8)	Digital Interrupt(PB15)	Temperature(SHT20 or SHT31 or BH1750 Illumination Sensor)	Humidity(SHT20 or SHT31)	Bat

The screenshot shows a log entry for an uplink data message at 18:56:18. The MAC payload is 9B B9 12 65 74 27 28 60 64 E7 D8 AB. The raw payload is 00 93 01 1A 01 00 98 01 1E 01 17. Red arrows point from the raw payload bytes to labels: 00 93 to Battery Info, 01 1A to ADC1, 01 00 to ADC2, 98 to ADC3, 01 1E to Digital Interrupt, and 01 17 to Temperature (SHT20 or SHT31). Other annotations include Humidity (SHT20 or SHT31) pointing to the payload structure and another Temperature (SHT20 or SHT31) pointing to the raw payload.

2.3.2.4 MOD=4 (3 x DS18B20)

This mode has total 11 bytes. As shown below:

Size(bytes)	2	2	2	1	2	2
Value	BAT	Temperature1(DS18B20) (PC13)	ADC(PA4)	Digital in(PB15) & Digital Interrupt(PA8)	Temperature2(DS18B20) (PB9)	Temperature3(DS18B20) (PB8)

The screenshot shows a log entry for an uplink data message at 18:56:18. The MAC payload is 13 4F 40 ED C8 AB 77 E8 53 68 28. The raw payload is 00 93 01 1A 01 00 98 01 1E 01 17. Red arrows point from the raw payload bytes to labels: 00 93 to Battery Info, 01 1A to ADC, 01 00 to Digital Input and Digital Interrupt, 98 to Temperature1 (DS18B20), 01 1E to Temperature2 (DS18B20), and 01 17 to Temperature3 (DS18B20).



2.3.2.5 MOD=5(Weight Measurement by HX711)

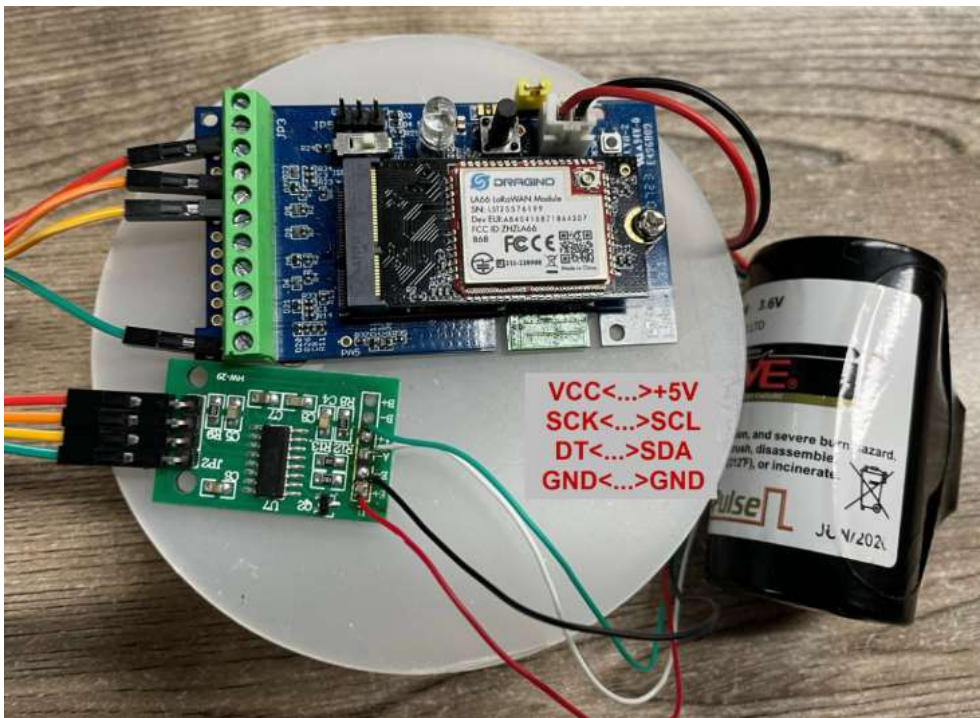

Each HX711 need to be calibrated before used. User need to do below two steps:

1. Zero calibration. Don't put anything on load cell and run **AT+WEIGRE** to calibrate to Zero gram.
2. Adjust calibration factor (default value 400): Put a known weight thing on load cell and run **AT+WEIGAP** to adjust the Calibration Factor.
3. Weight has 4 bytes, the unit is g.

For example:

AT+GETSENSORVALUE =0

Response: Weight is 401 g

Check the response of this command and adjust the value to match the real value for thing.

Size(bytes)	2	2	2	1	4
-------------	---	---	---	---	---

Value	BAT	Temperature(DS18B20) (PC13)	ADC(PA4)	Digital in(PB15) & Digital Interrupt(PA8)	Weight
-------	-----	--------------------------------	----------	--	--------

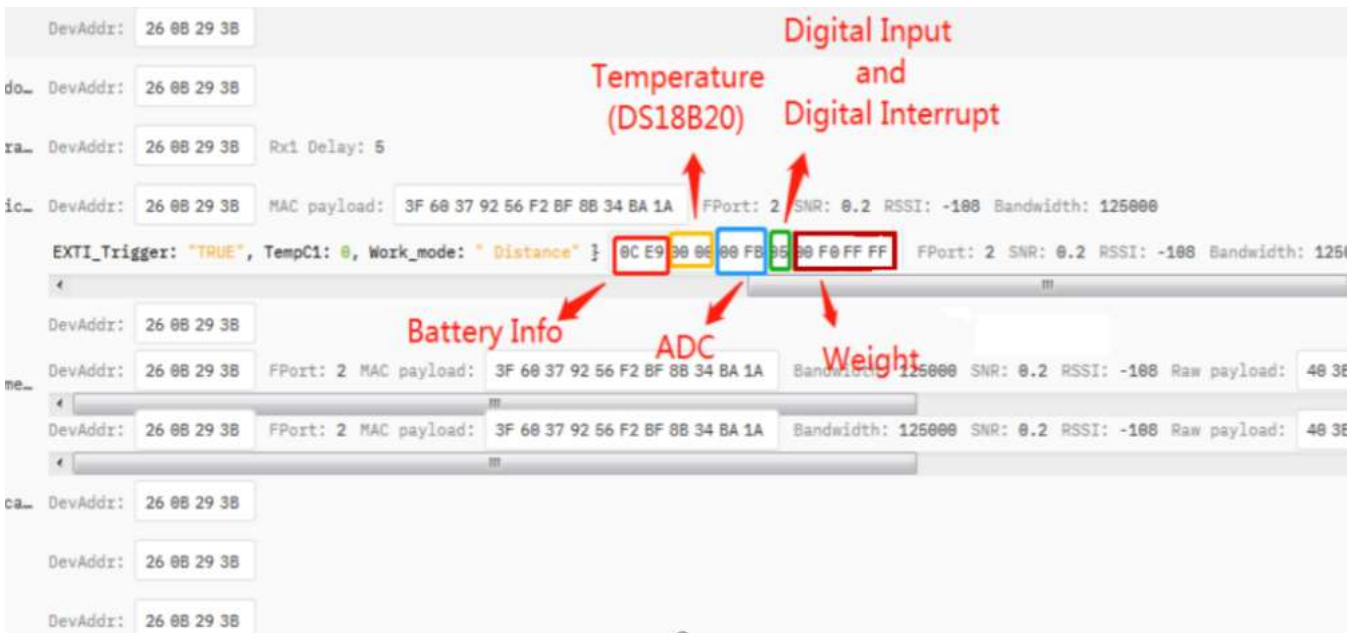

2.3.2.6 MOD=6 (Counting Mode)

In this mode, the device will work in counting mode. It counts the interrupt on the interrupt pins and sends the count on TDC time.

Connection is as below. The PIR sensor is a count sensor, it will generate interrupt when people come close or go away. User can replace the PIR sensor with other count sensor.

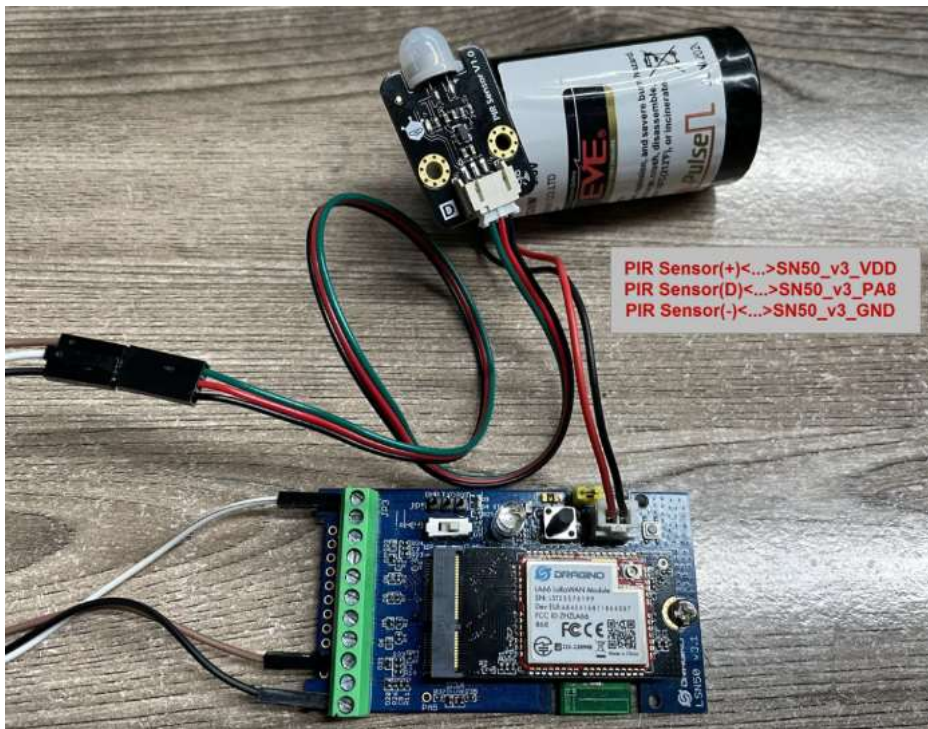

Note: LoRaWAN wireless transmission will infect the PIR sensor. Which cause the counting value increase +1 for every uplink. User can change PIR sensor or avoid this happen.

Size(bytes)	2	2	2	1	4
Value	BAT	Temperature(DS18B20) (PC13)	ADC(PA4)	Digital in(PB15)	Count(PA8)

2.3.2.7 MOD=7 (Three interrupt contact modes)

Size(bytes)	2	2	2	1	1	1	2
Value	BAT	Temperature(DS18B20) (PC13)	ADC(PA5)	Digital Interrupt1(PA8)	Digital Interrupt2(PA4)	Digital Interrupt3(PB15)	Reserved

2.3.2.8 MOD=8 (3ADC+1DS18B20)

Size(bytes)	2	2	2	1	2	2
Value	BAT	Temperature(DS18B20) (PC13)	ADC1(PA4)	Digital Interrupt(PB15)	ADC2(PA5)	ADC3(PA8)

2.3.2.9 MOD=9 (3DS18B20+ two Interrupt count mode)

Size(bytes)	2	2	2	1	2	4	4
-------------	---	---	---	---	---	---	---

Value	BAT	Temperature (DS18B20) (PC13)	Temperature2 (DS18B20) (PB9)	Digital Interrupt (PB15)	Temperature3 (DS18B20) (PB8)	Count1(PA8)	Count2(PA4)
-------	-----	------------------------------	------------------------------	--------------------------	------------------------------	-------------	-------------

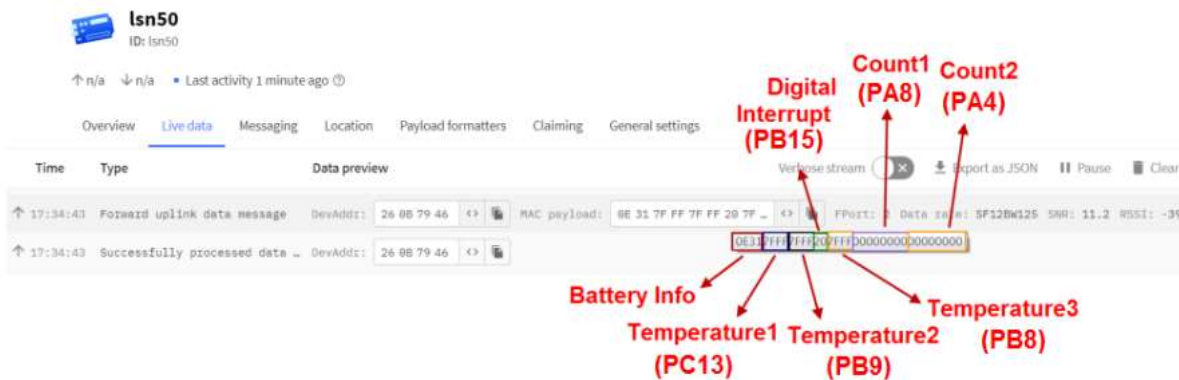

The newly added AT command is issued correspondingly:

AT+INTMOD1 PA8 pin: Corresponding downlink: **06 00 00 xx**

AT+INTMOD2 PA4 pin: Corresponding downlink: **06 00 01 xx**

AT+INTMOD3 PB15 pin: Corresponding downlink: **06 00 02 xx**

AT+SETCNT=aa,bb

When AA is 1, set the count of PA8 pin to BB Corresponding downlink: 09 01 bb bb bb bb

When AA is 2, set the count of PA4 pin to BB Corresponding downlink: 09 02 bb bb bb bb bb

2.3.3 Decode payload

While using TTN V3 network, you can add the payload format to decode the payload.

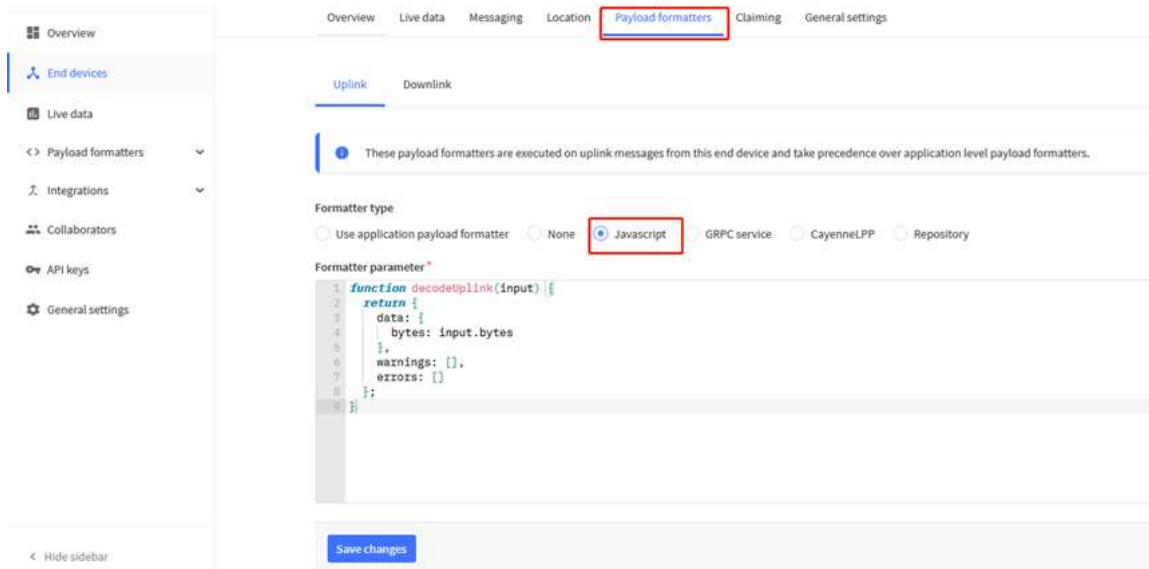

The payload decoder function for TTN V3 are here:

SN50v3-LB TTN V3 Payload Decoder: <https://github.com/dragino/dragino-end-node-decoder> (<https://github.com/dragino/dragino-end-node-decoder>)

2.3.3.1 Battery Info

Check the battery voltage for SN50v3-LB.

Ex1: 0x0B45 = 2885mV

Ex2: 0x0B49 = 2889mV

2.3.3.2 Temperature (DS18B20)

If there is a DS18B20 connected to PC13 pin. The temperature will be uploaded in the payload.

More DS18B20 can check the 3 DS18B20 mode

Connection:



Example:

If payload is: 0105H: (0105 & 8000 == 0), temp = 0105H /10 = 26.1 degree

If payload is: FF3FH : (FF3F & 8000 == 1) , temp = (FF3FH - 65536)/10 = -19.3 degrees.

(FF3F & 8000: Judge whether the highest bit is 1, when the highest bit is 1, it is negative)

2.3.3.3 Digital Input

The digital input for pin PB15,

- When PB15 is high, the bit 1 of payload byte 6 is 1.
- When PB15 is low, the bit 1 of payload byte 6 is 0.

When the digital interrupt pin is set to AT+INTMODx=0, this pin is used as a digital input pin.

Note: The maximum voltage input supports 3.6V.

2.3.3.4 Analogue Digital Converter (ADC)

The measuring range of the ADC is only about 0V to 1.1V The voltage resolution is about 0.24mv.

When the measured output voltage of the sensor is not within the range of 0V and 1.1V, the output voltage terminal of the sensor shall be divided The example in the following voltage of the sensor by three times If it is necessary to reduce more times, calculate according to the formula in the figure and connect the corresponding resistance in s

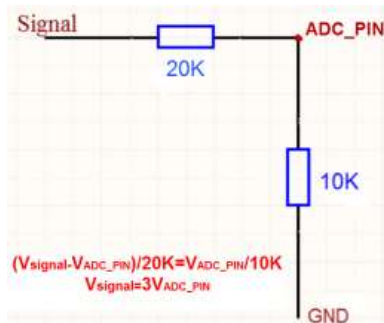

Note: If the ADC type sensor needs to be powered by SN50_v3, it is recommended to use +5V to control its switch. Only sensors with low power consumption

2.3.3.5 Digital Interrupt

Digital Interrupt refers to pin PA8, and there are different trigger methods. When there is a trigger, the SN50v3-LB will send a packet to the server.

Interrupt connection method:

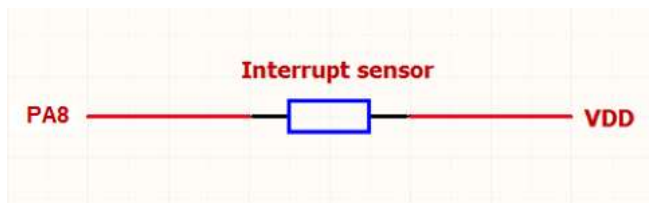

Example to use with door sensor :

The door sensor is shown at right. It is a two wire magnetic contact switch used for detecting the open/close status of doors or windows.

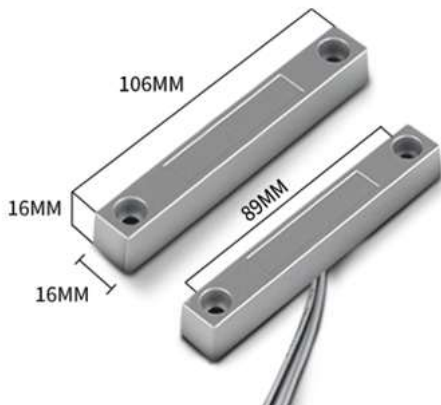

When the two pieces are close to each other, the 2 wire output will be short or open (depending on the type), while if the two pieces are away from each other, the 2 wire can use SN50v3-LB interrupt interface to detect the status for the door or window.

Below is the installation example:

Fix one piece of the magnetic sensor to the door and connect the two pins to SN50v3-LB as follows:

- One pin to SN50v3-LB's PA8 pin
- The other pin to SN50v3-LB's VDD pin

Install the other piece to the door. Find a place where the two pieces will be close to each other when the door is closed. For this particular magnetic sensor, when the door is closed, the PA8 will be at the VCC voltage.

Door sensors have two types: **NC (Normal close)** and **NO (normal open)**. The connection for both type sensors are the same. But the decoding for payload are reverse Server decoder.

When door sensor is shorted, there will extra power consumption in the circuit, the extra current is $3v3/R14 = 3v3/1M\Omega = 3\mu A$ which can be ignored.

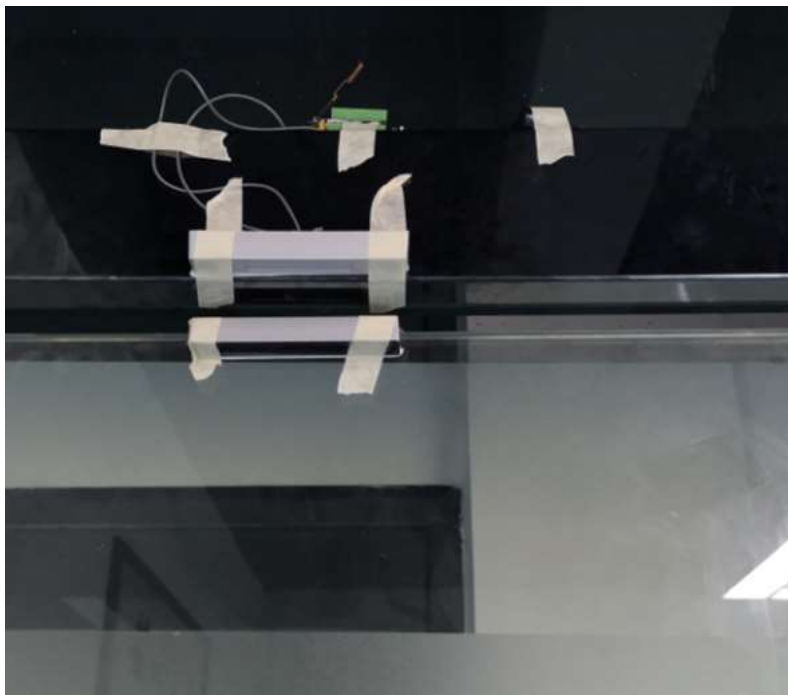

The above photos shows the two parts of the magnetic switch fitted to a door.

The software by default uses the falling edge on the signal line as an interrupt. We need to modify it to accept both the rising edge (0v --> VCC , door close) and the fallin interrupt.

The command is:

```
AT+INTMOD1=1 // (more info about INMOD please refer AT Command Manual (http://www.dragino.com/downloads/index.php?dir=LSN50-LoRaST/&file=DRAGINO_LSN50_AT_Commands_v1.5.1.pdf) .)
```

Below shows some screen captures in TTN V3:



In **MOD=1**, user can use byte 6 to see the status for door open or close. TTN V3 decoder is as below:

door= (bytes[6] & 0x80)? "CLOSE":"OPEN";

2.3.3.6 I2C Interface (SHT20 & SHT31)

The SDA and SCL are I2C interface lines. You can use these to connect to an I2C device and get the sensor data.

We have made an example to show how to use the I2C interface to connect to the SHT20/ SHT31 Temperature and Humidity Sensor.

Notice: Different I2C sensors have different I2C commands set and initiate process, if user want to use other I2C sensors, User need to re-write the source code SHT31 code in SN50v3-LB will be a good reference.

Below is the connection to SHT20/ SHT31. The connection is as below:

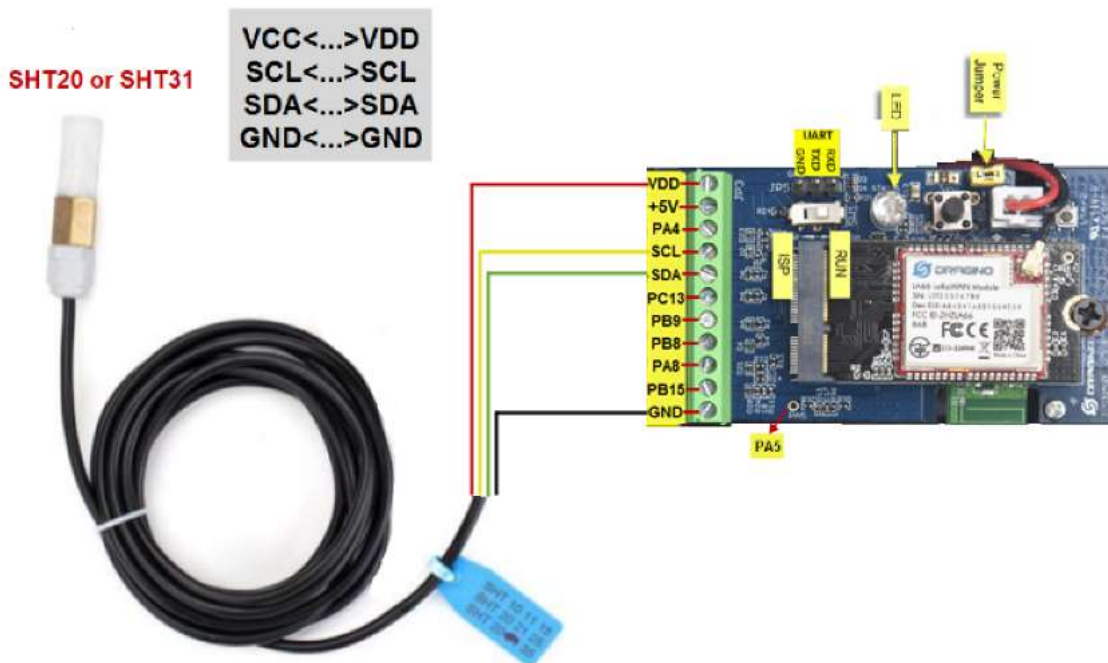

The device will be able to get the I2C sensor data now and upload to IoT Server.

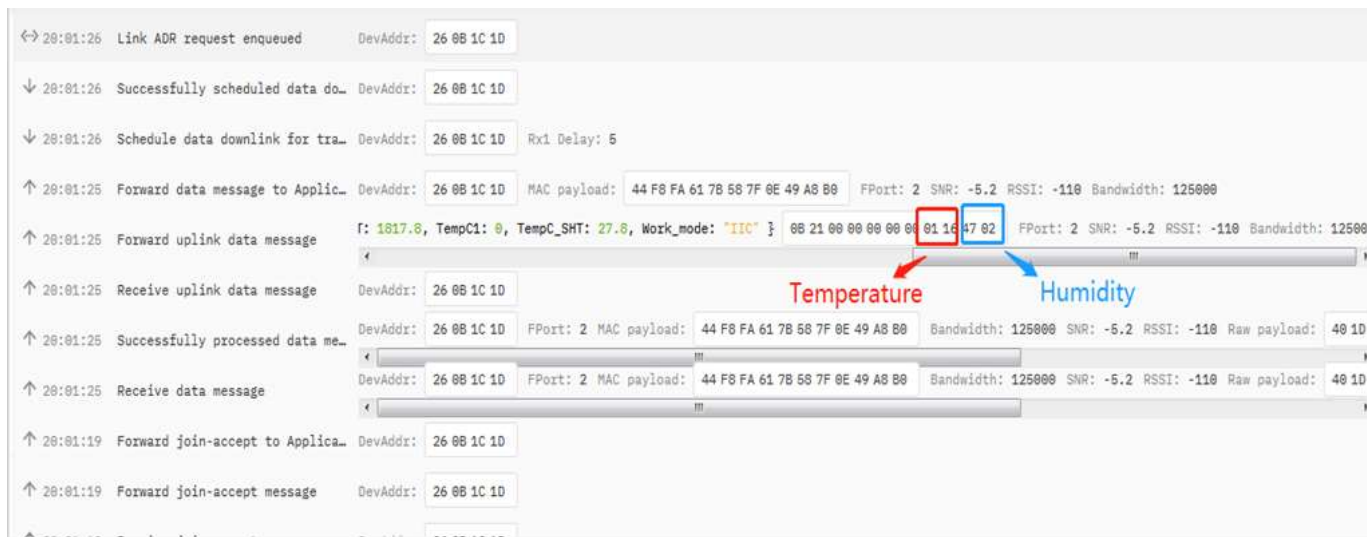

Convert the read byte to decimal and divide it by ten.

Example:

Temperature: Read:0116(H) = 278(D) Value: 278 /10=27.8°C;

Humidity: Read:0248(H)=584(D) Value: 584 / 10=58.4, So 58.4%

If you want to use other I2C device, please refer the SHT20 part source code as reference.

2.3.3.7 Distance Reading

Refer Ultrasonic Sensor section.

2.3.3.8 Ultrasonic Sensor

This Fundamental Principles of this sensor can be found at this link: https://wiki.dfrobot.com/Weather_-_proof_Ultrasonic_Sensor_with_Separate_Probe_SKU___SEN021__proof_Ultrasonic_Sensor_with_Separate_Probe_SKU___SEN0208

The SN50v3-LB detects the pulse width of the sensor and converts it to mm output. The accuracy will be within 1 centimeter. The usable range (the distance between the object) is between 24cm and 600cm.

The working principle of this sensor is similar to the **HC-SR04** ultrasonic sensor.

The picture below shows the connection:

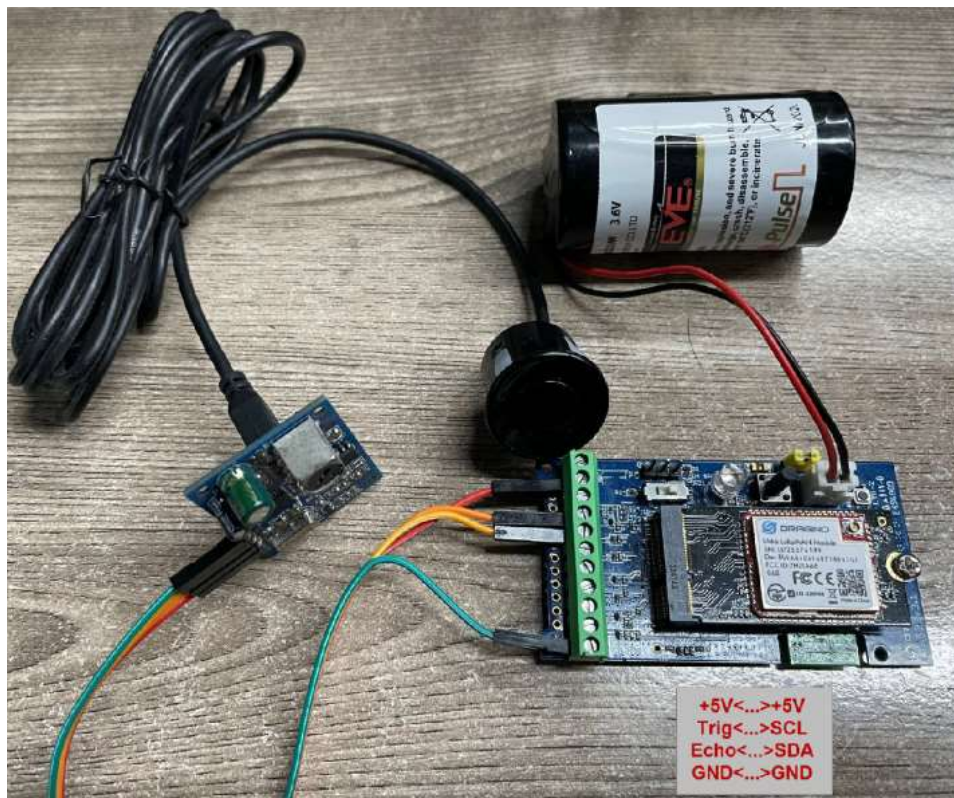

Connect to the SN50v3-LB and run **AT+MOD=2** to switch to ultrasonic mode (ULT).

The ultrasonic sensor uses the 8th and 9th byte for the measurement value.

Example:

Distance: Read: 0C2D(Hex) = 3117(D) Value: 3117 mm=311.7 cm

2.3.3.9 Battery Output - BAT pin

The BAT pin of SN50v3-LB is connected to the Battery directly. If users want to use BAT pin to power an external sensor. User need to make sure the external sensor is c BAT pin is always open. If the external sensor is of high power consumption. the battery of SN50v3-LB will run out very soon.

2.3.3.10 +5V Output

SN50v3-LB will enable +5V output before all sampling and disable the +5v after all sampling.

The 5V output time can be controlled by AT Command.

AT+5VT=1000

Means set 5V valid time to have 1000ms. So the real 5V output will actually have 1000ms + sampling time for other sensors.

By default the **AT+5VT=500**. If the external sensor which require 5v and require more time to get stable state, user can use this command to increase the power ON dura

2.3.3.11 BH1750 Illumination Sensor

MOD=1 support this sensor. The sensor value is in the 8th and 9th bytes.

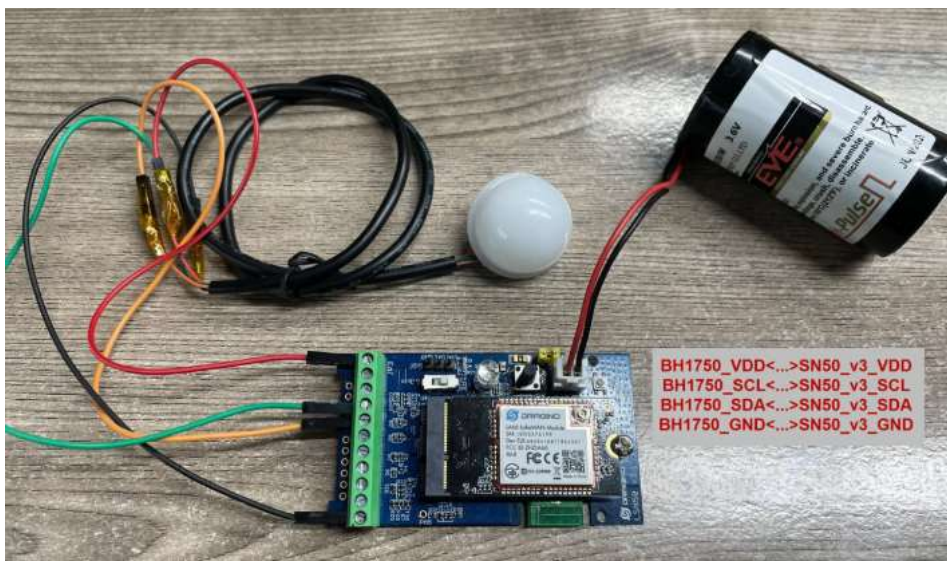

```

DevAddr: 26 0B F3 D8
DevAddr: 26 0B F3 D8
DevAddr: 26 0B F3 D8 Rx1 Delay: 5
DevAddr: 26 0B F3 D8 MAC payload: A6 B6 50 7F C3 13 F9 7C 59 BF AF FPort: 2 SNR: -4.8 RSSI: -111 Bandwidth: 125000
Digital_IStatus: "L", Door_status: "OPEN", EXTI_Trigger: "FALSE", Illum: 53, TempC1: 0, Work_mode: "IIC" } 0C E7 00 00 00 A2 00 00 35 00 00
DevAddr: 26 0B F3 D8
DevAddr: 26 0B F3 D8 FPort: 2 MAC payload: A6 B6 50 7F C3 13 F9 7C 59 BF AF Bandwidth: 125000 SNR: -4.8 RSSI: -111 Raw payload: 40 D8 F
DevAddr: 26 0B F3 D8 FPort: 2 MAC payload: A6 B6 50 7F C3 13 F9 7C 59 BF AF Bandwidth: 125000 SNR: -4.8 RSSI: -111 Raw payload: 40 D8 F
DevAddr: 26 0B F3 D8
DevAddr: 26 0B F3 D8

```

2.3.3.12 Working MOD

The working MOD info is contained in the Digital in & Digital Interrupt byte (7th Byte).

User can use the 3rd ~ 7th bit of this byte to see the working mod:

Case 7th Byte >> 2 & 0x1f:

- 0: MOD1
- 1: MOD2
- 2: MOD3
- 3: MOD4

- 4: MOD5
- 5: MOD6
- 6: MOD7
- 7: MOD8
- 8: MOD9

2.4 Payload Decoder file

In TTN, use can add a custom payload so it shows friendly reading

In the page **Applications --> Payload Formats --> Custom --> decoder** to add the decoder from:

https://github.com/dragino/dragino-end-node-decoder/tree/main/SN50_v3-LB (https://github.com/dragino/dragino-end-node-decoder/tree/main/SN50_v3-LB)

2.5 Frequency Plans

The SN50v3-LB uses OTAA mode and below frequency plans by default. If user want to use it with different frequency plan, please refer the AT command sets.

<http://wiki.dragino.com/xwiki/bin/view/Main/End%20Device%20Frequency%20Band/> (<http://wiki.dragino.com/xwiki/bin/view/Main/End%20Device%20Frequency%20Band/>)

3. Configure SN50v3-LB

3.1 Configure Methods

SN50v3-LB supports below configure method:

- AT Command via Bluetooth Connection (**Recommended**): BLE Configure Instruction (<http://wiki.dragino.com/xwiki/bin/view/Main/BLE%20Bluetooth%20Remote%20Device%20Configure%20Instruction/>)
- AT Command via UART Connection : See UART Connection (<http://wiki.dragino.com/xwiki/bin/view/Main/UART%20Access%20for%20LoRa%20ST%20v4%20base%20model/#H2.3UARTConnectionforSN50v3basemotherbo>)
- LoRaWAN Downlink. Instruction for different platforms: See IoT LoRaWAN Server (<http://wiki.dragino.com/xwiki/bin/view/Main/>) section.

3.2 General Commands

These commands are to configure:

- General system settings like: uplink interval.
- LoRaWAN protocol & radio related command.

They are same for all Dragino Devices which support DLWS-005 LoRaWAN Stack. These commands can be found on the wiki:

<http://wiki.dragino.com/xwiki/bin/view/Main/End%20Device%20AT%20Commands%20and%20Downlink%20Command/>
(<http://wiki.dragino.com/xwiki/bin/view/Main/End%20Device%20AT%20Commands%20and%20Downlink%20Command/>)

3.3 Commands special design for SN50v3-LB

These commands only valid for SN50v3-LB, as below:

3.3.1 Set Transmit Interval Time

Feature: Change LoRaWAN End Node Transmit Interval.

AT Command: AT+TDC

Command Example	Function	Response
AT+TDC=?	Show current transmit Interval	30000 OK the interval is 30000ms = 30s
AT+TDC=60000	Set Transmit Interval	OK Set transmit interval to 60000ms = 60 seconds

Downlink Command: 0x01

Format: Command Code (0x01) followed by 3 bytes time value.

If the downlink payload=0100003C, it means set the END Node's Transmit Interval to 0x00003C=60(S), while type code is 01.

- Example 1: Downlink Payload: 0100001E // Set Transmit Interval (TDC) = 30 seconds
- Example 2: Downlink Payload: 0100003C // Set Transmit Interval (TDC) = 60 seconds

3.3.2 Get Device Status

Send a LoRaWAN downlink to ask the device to send its status.

Downlink Payload: 0x26 01

Sensor will upload Device Status via **FPORT=5**. See payload section for detail.

3.3.3 Set Interrupt Mode

Feature, Set Interrupt mode for GPIO_EXIT.

AT Command: AT+INTMOD1, AT+INTMOD2, AT+INTMOD3

Command Example	Function	Response
AT+INTMOD1=?	Show current interrupt mode	0 OK the mode is 0 =Disable Interrupt
AT+INTMOD1=2	Set Transmit Interval 0. (Disable Interrupt), 1. (Trigger by rising and falling edge) 2. (Trigger by falling edge) 3. (Trigger by rising edge)	OK
AT+INTMOD2=3	Set Transmit Interval trigger by rising edge.	OK
AT+INTMOD3=0	Disable Interrupt	OK

Downlink Command: 0x06

Format: Command Code (0x06) followed by 3 bytes.

This means that the interrupt mode of the end node is set to 0x000003=3 (rising edge trigger), and the type code is 06.

- Example 1: Downlink Payload: 06000000 --> AT+INTMOD1=0
- Example 2: Downlink Payload: 06000003 --> AT+INTMOD1=3
- Example 3: Downlink Payload: 06000102 --> AT+INTMOD2=2
- Example 4: Downlink Payload: 06000201 --> AT+INTMOD3=1

3.3.4 Set Power Output Duration

Control the output duration 5V . Before each sampling, device will

1. first enable the power output to external sensor,
2. keep it on as per duration, read sensor value and construct uplink payload
3. final, close the power output.

AT Command: AT+5VT

Command Example	Function	Response
AT+5VT=?	Show 5V open time.	500(default) OK
AT+5VT=1000	Close after a delay of 1000 milliseconds.	OK

Downlink Command: 0x07

Format: Command Code (0x07) followed by 2 bytes.

The first and second bytes are the time to turn on.

- Example 1: Downlink Payload: 070000 --> AT+5VT=0
- Example 2: Downlink Payload: 0701F4 --> AT+5VT=500

3.3.5 Set Weighing parameters

Feature: Working mode 5 is effective, weight initialization and weight factor setting of HX711.

AT Command: AT+WEIGRE,AT+WEIGAP

Command Example	Function	Response
AT+WEIGRE	Weight is initialized to 0.	OK
AT+WEIGAP=?	400.0	OK(default)
AT+WEIGAP=400.3	Set the factor to 400.3.	OK

Downlink Command: 0x08

Format: Command Code (0x08) followed by 2 bytes or 4 bytes.

Use AT+WEIGRE when the first byte is 1, only 1 byte. When it is 2, use AT+WEIGAP, there are 3 bytes.

The second and third bytes are multiplied by 10 times to be the AT+WEIGAP value.

- Example 1: Downlink Payload: 0801 ---> AT+WEIGRE
- Example 2: Downlink Payload: 08020FA3 ---> AT+WEIGAP=400.3
- Example 3: Downlink Payload: 08020FA0 ---> AT+WEIGAP=400.0

3.3.6 Set Digital pulse count value

Feature: Set the pulse count value.

Count 1 is PA8 pin of mode 6 and mode 9. Count 2 is PA4 pin of mode 9.

AT Command: AT+SETCNT

Command Example	Function	Response
AT+SETCNT=1,100	Initialize the count value 1 to 100.	OK
AT+SETCNT=2,0	Initialize the count value 2 to 0.	OK

Downlink Command: 0x09

Format: Command Code (0x09) followed by 5 bytes.

The first byte is to select which count value to initialize, and the next four bytes are the count value to be initialized.

- Example 1: Downlink Payload: 090100000000 ---> AT+SETCNT=1,0
- Example 2: Downlink Payload: 0902000003E8 ---> AT+SETCNT=2,1000

3.3.7 Set Workmode

Feature: Switch working mode.

AT Command: AT+MOD

Command Example	Function	Response
AT+MOD=?	Get the current working mode.	OK
AT+MOD=4	Set the working mode to 3DS18B20s.	OK Attention:Take effect after ATZ

Downlink Command: 0x0A

Format: Command Code (0x0A) followed by 1 bytes.

- Example 1: Downlink Payload: 0A01 ---> AT+MOD=1
- Example 2: Downlink Payload: 0A04 ---> AT+MOD=4

4. Battery & Power Consumption

SN50v3-LB use ER26500 + SPC1520 battery pack. See below link for detail information about the battery info and how to replace.

Battery Info & Power Consumption Analyze (<http://wiki.dragino.com/xwiki/bin/view/Main/How%20to%20calculate%20the%20battery%20life%20of%20Dragino%20sen>)

5. OTA Firmware update

User can change firmware SN50v3-LB to:

- Change Frequency band/ region.
- Update with new features.
- Fix bugs.

Firmware and changelog can be downloaded from : Firmware download link (<https://www.dropbox.com/sh/4rov7bcp6u28exp/AACT-wAySd4si5AXi8DBmvSca1>)

Methods to Update Firmware:

- (Recommended way) OTA firmware update via wireless: <http://wiki.dragino.com/xwiki/bin/view/Main/Firmware%20OTA%20Update%20for%20Sensors/> (<http://wiki.dragino.com/xwiki/bin/view/Main/Firmware%20OTA%20Update%20for%20Sensors/>)
- Update through UART TTL interface. **Instruction** (<http://wiki.dragino.com/xwiki/bin/view/Main/UART%20Access%20for%20LoRa%20ST%20v4%20base%20model/#H1.LoRaSTv4baseHardware>)

6. FAQ

6.1 Where can i find source code of SN50v3-LB?

- **Hardware Source Files** (<https://github.com/dragino/Lora/tree/master/LSN50v3.0>)
- **Software Source Code & Compile instruction** (<https://github.com/dragino/SN50v3>)

7. Order Info

Part Number: **SN50v3-LB-XX-YY**

XX: The default frequency band

- **AS923:** LoRaWAN AS923 band
- **AU915:** LoRaWAN AU915 band
- **EU433:** LoRaWAN EU433 band
- **EU868:** LoRaWAN EU868 band
- **KR920:** LoRaWAN KR920 band
- **US915:** LoRaWAN US915 band
- **IN865:** LoRaWAN IN865 band
- **CN470:** LoRaWAN CN470 band

YY: Hole Option

- **12:** With M12 waterproof cable hole
- **16:** With M16 waterproof cable hole
- **20:** With M20 waterproof cable hole
- **NH:** No Hole

8. Packing Info

Package Includes:

- SN50v3-LB LoRaWAN Generic Node

Dimension and weight:

- Device Size: cm
- Device Weight: g
- Package Size / pcs : cm
- Weight / pcs : g

9. Support

- Support is provided Monday to Friday, from 09:00 to 18:00 GMT+8. Due to different timezones we cannot offer live support. However, your questions will be answered according to the mentioned schedule.
- Provide as much information as possible regarding your enquiry (product models, accurately describe your problem and steps to replicate it etc) and send a mail to (dragino@dragino.com)

♥ 0 Tags:

Created by Edwin Chen ([/xwiki/bin/view/XWiki/Edwin](http://wiki.dragino.com/xwiki/bin/view/XWiki/Edwin)) on 2023/05/11 20:14

No comments for this page