

((SENSONEO))

# Single sensor 3.0

Installation guide 2019

[www.sensoneo.com/knowledge](http://www.sensoneo.com/knowledge)

## INTRODUCTION

Sensoneo Single Sensor 3.0 is an enterprise class device monitoring fill-level of various types of containers. It uses single ultrasonic beam with measurement from 1 cm up to the depth of 255 cm.

The sensor provides configurable accelerometer for tilt recognition which sends notification immediately. Sensor is configurable via Bluetooth Configurator app. You can configure fire alarm, measurement frequency, actual time and more. The sensor is powered by replaceable batteries which frequently inform the operator about their capacity.

### Package Contents

The package contains the following:

- Single Sensor LoRa/Sigfox or LoRa/NBIoT



- Mounting kit

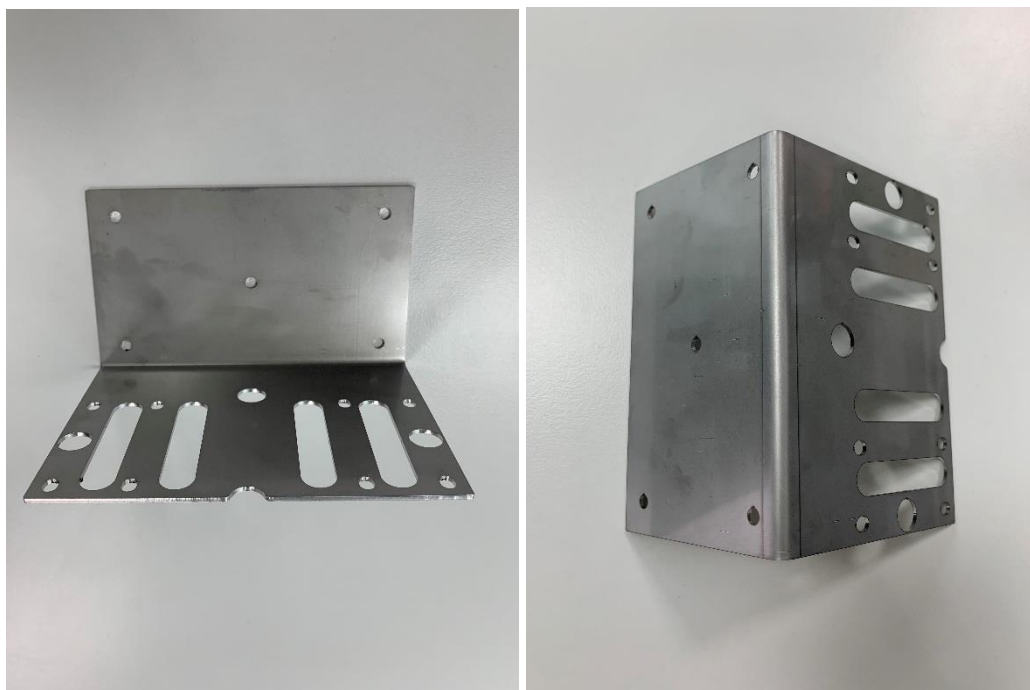

- Magnet

*Note 1: Magnet may not be part of the package if the air-post has been used for delivery. There are respective air-post restrictions.*

*Note 2: Battery may not be part of the package if the air-post has been used for delivery. There are respective air-post restrictions.*

## PHYSICAL INSTALLATION INSTRUCTIONS

### Choose Your Mounting Location

A good mounting location is important to getting the best performance out of your sensor. Keep the following in mind:

1. The device should be pointing down to the center of the bottom of the container, bear in mind that the measurement is starting 2 cm below the sensor. When installing on the lid then the sensor should be at least 40 cm from the side wall of the container (position A). When installing on the side wall then the sensor has to point away from the wall as shown in the picture (position B). Picture (position C) shows incorrect installation.

### CORRECT INSTALLATION

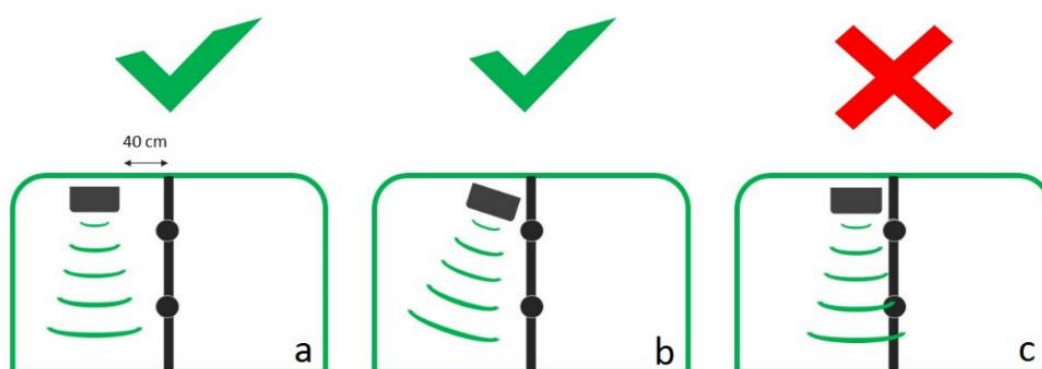

2. Make sure that you are in the range of network signal and your sensors ID is registered in the network. The ID can be found on the label.
3. Batteries you are using are recommended by vendor: Battery AA lithium 3.6V (e.g. SAFT LS 14500)

## Sensor initialization

1. If missing, place the batteries into the sensor by loosening the screws as shown.



2. Attach the magnet to the sensor as shown in the picture (turn On/ Off ), you will hear the short beep 4 times.



3. After initialization sensor starts to measure and logs into the network. Within 1 minute you should hear short beep 1 time. If the transmission is not complete you can hear short beep 2 times. In that case, you have to check whether the measurement was transferred to Sensoneo Waste Management System. Make sure you are in the coverage area of the network signal.

*Note: If needed then attaching the magnet again on the same place will switch off the sensor with the 1-time long beep tone confirmation.*

### Physical installation into the container

1. Fix the sensor on the mounting kit with rivets. Recommending the use of silicon on top for protection from water.



2. Fix the mounting kit with the sensor in the container. E.g. you can install sensor on the side wall of container, on the top/lid of the container, it depends on the type and size of the container.



Please point the transmitter resonator (marked yellow) to the center of the bin. Do not point the sensor axis to the center. Pointing the transmitter to the center of the bin is important to achieve better measurement results, especially for smaller container sizes.





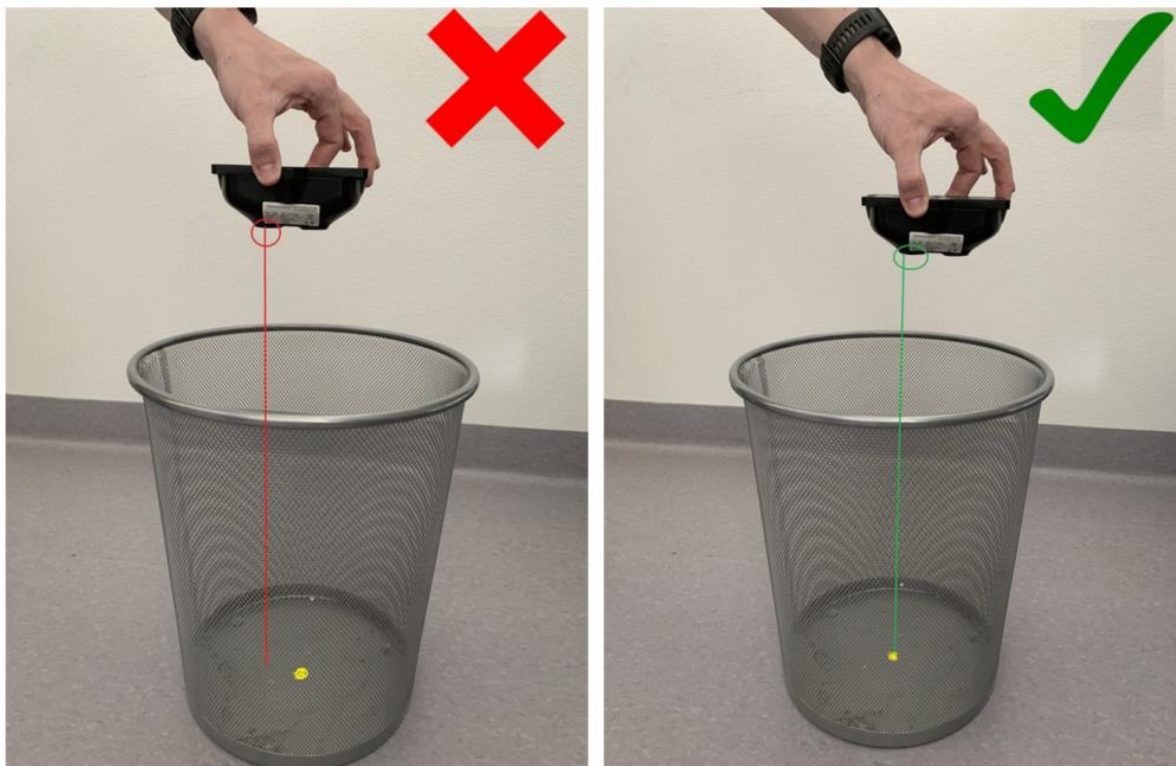

*\*please note, that pictures are just for illustration, Single sensor is not suitable for this kind of bin*

### Configuration via Sensoneo Configurator App

- Log in to Sensoneo Configurator App for sensor registration and configuration.  
Configurator App is available for free on Google Play:  
<https://play.google.com/store/apps/details?id=com.casperise.configurator&hl=en>
- Follow the instructions in the Configurator App user manual.





**Sensoneo enables  
a world that is  
green, clean and  
free of litter**